



# King Vision® aBlade video laryngoscope

**Portable. Affordable. Durable.**

# King Vision® aBlade™

## Video laryngoscope



### Key Benefits

#### Affordable

- The King Vision® aBlade is an excellent solution to solve the issue of limited availability of advanced visualisation solutions in the OR.
- With King Vision® you can improve patient care by having high performance visualisation capabilities for every intubation, at an affordable price.

#### Portable

- King Vision® is light weight, self-contained, battery operated and water resistant. King Vision® can be used continuously for more than 90 minutes making it highly portable.
- The aBlades are individually packaged. Each blade is disposable, eliminating concerns of cross contamination. King Vision® offers the choice of two blade types depending on preferred tube delivery technique.

#### Durable

- King Vision® and aBlades have been designed to be your primary tool for all intubations.
- Video output capability is compatible with external monitor and recording devices.
- The robust, full-colour, non-glare display can resist repeated cleaning. The aBlade video adapter is reusable, designed with materials that can withstand repeated use.

## King Vision® video laryngoscope

Visionary performance in the palm of your hand. When it comes to visualising the airway for routine or difficult intubations, you need a tool that you can depend on each and every time. King Vision® is designed for indirect visualisation of the vocal cords which minimise the need for tissue manipulation and improve the ability to see anterior airways. Such reliable performance is a necessity, not an option. King Vision® comes with the choice of two blade types that allow users to keep their preferred technique in terms of tube delivery, offering an unique flexibility.

#### Portable

The King Vision® display is light weight, self-contained, battery operated, and water resistant. The reusable display and video adapter come packaged in a protective case. aBlades are individually packaged making King Vision® very portable.

#### Affordable

The disposable blades allow for economical use of the King Vision® for most of your intubations. Combined with the high performance visualisation capabilities this offers great value while also delivering excellent patient care. Take the guess-work out of your intubations. See the vocal cords and confirm placement of the endotracheal tube.

#### Durable

The King Vision® is designed to be your primary tool for intubations. The high-quality display comes with a 1-year warranty. The robust, full-colour, smudge-proof, non-glare display can resist repeated cleaning and normal use wear and tear.



## Ordering specifications

Item no.	Description	Quantity
KVLAB3	Standard aBlade	20/CS
KVLAB3C	Channeled aBlade	20/CS
KVLVA34	aBlade Video Adapter 34	1/CS
KVLABKIT3	aBlade Kit	1/CS
KVIS01VA34	1 Display and 1 Video Adapter 34	1/CS
KVIS01ADCASE	aBlade case	1/CS

Part	Material
Blade	Polycarbonate, TPE (Thermoplastic Polyurethane Elastomer)
Video adapter	Polycarbonate/ABS, TPE (Thermoplastic Polyurethane Elastomer)
Display	Polycarbonate/ABS anti-reflective coating on display window

**Sales Company**  
**Ambu A/S**  
 Baltorpbakken 13  
 DK - 2750 Ballerup  
 Denmark  
 Tel. +45 7225 2000  
 Fax +45 7225 2053  
 www.ambu.com

**Manufacturer**  
**King Systems**  
 15011 Herriman Boulevard  
 Noblesville, IN 46060  
 Tel. 317 776 6823  
 Tel. 800 642 5464  
 Fax 317 776 6827  
 www.Kingsystems.com



**MERT**  
 EMERICAL SOLUTIONS. BUSINESS

CE US: Rx only

King Vision® has been designed with the intention to make a revolutionary series of high performance portable video laryngoscopes. The King Vision® combines the convenience of a durable reusable, video system with a disposable blade at a price that's affordable for all of your intubations, difficult and routine.

Learn more at [www.airwaylearning.com](http://www.airwaylearning.com)

## BETTER PATIENT CARE

The King Vision® is ergonomically designed to provide minimal lifting of soft tissue and impact on teeth.



## PRODUCT SPECIFICATIONS

REUSABLE DISPLAY/ VIDEO ADAPTER				DISPOSABLE BLADES	
Batteries	3 AAA (Alkaline recommended)	Material	Polycarbonate / ABS anti-reflective coating on display window	Anti-fog	Coating on distal lens
Battery Life	About 90 min. (Battery status indicator flashes red when batteries need to be changed).	Camera Chip	CMOS	AP Height of Blade	13 mm (non-channeled); 18 mm (channeled)
Computerized Power Management System	Automatic gain and exposure control	Camera Resolution	640 x 480 VGA	Blade Length	17 cm
Video Aspect Ratio	4:3	Light Source	White LED		
Video Port	RCA connection to monitor with cable			Blade Width	26 mm (standard); 29 mm (channeled); 16 mm at distal tip
Video Refresh Rate	30 frames per second			Disposable Material	polycarbonate/TPE
Video Resolution	320 x 240 (QVGA)			ET Size	6.0 mm - 8.0 mm (Channeled Blade)
Video Screen	OLCD Display				
Video Screen Size	6.1 cm / 2.4" diagonal				

## ORDERING SPECIFICATIONS

ITEM NO.	DESCRIPTION	QUANTITY
KVLAB3	Standard aBlade, Size 3	20/CS
KVLAB3C	Channeled aBlade, Size 3	20/CS
KVLVA34	aBlade Video Adapter, Size 3	1/CS
KVLBKIT3	1 Vision Display, 1 Video Adapter, Case, AAA Batteries, 4 Channeled and 2 Standard aBlade	1/CS
KVIS01VA34	1 Display and 1 Video Adapter, Size 3	1/CS
KVCABL	Custom Video-out Cable (2.75 m / 9')	1/CS
KVIS01ADCASE	aBlade case	1/CS

**CE** US: Rx only

### Sales Company

**Ambu A/S**

Baltorpbakken 13  
DK - 2750 Ballerup  
Denmark  
Tel. +45 7225 2000  
Fax +45 7225 2053  
[www.ambu.com](http://www.ambu.com)

### Manufacturer

**King Systems**

15011 Herriman Boulevard  
Noblesville, IN 46060  
Tel. 317 776 6823  
Tel. 800 642 5464  
Fax 317 776 6827  
[www.Kingsystems.com](http://www.Kingsystems.com)

Distributed by  
**Ambu**

**MERT**  
EMERGOICAL SOLUTIONS. EMERGENCY

**Ambu**  
Ideas that work for life

# King Vision® aBlade

## Video laryngoscope

### Quick Guide

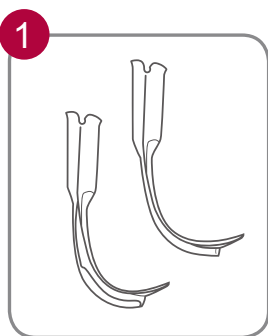

Select blade type



Slide on video adapter

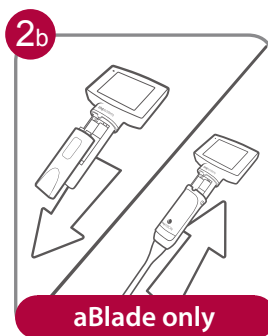

- Decide which blade type to use depending on technique. Channeled blade or standard blade.
- Connect blade to display before powering on
- No blade attached → no image; just static/snow
- Blade attached after display powered on → split image
- Blade disconnected from display → frozen image (for 20 sec) or auto shut off
- Note if display indicator turns red the display will turn off after approx. 15 minutes

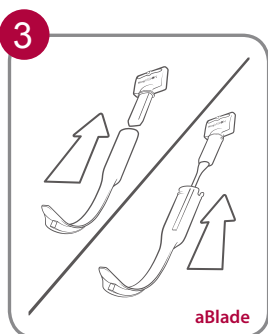

Attach blade

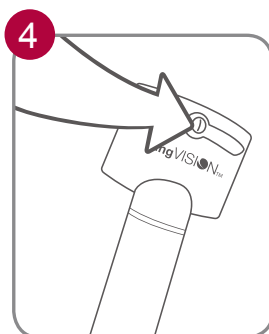

Power ON

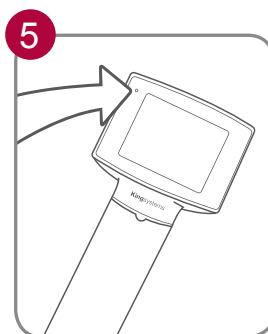

Test Battery & Image

- Lubricate blade and ETT keeping lubricant away from imaging sensor/camera window
- Channeled blade – Preload ETT into channeled if desired
- Standard blade – Install stylet in ETT and shape to match blade curve
- Power on and check for functional moving image
- Insert blade into mouth using mid-line approach; follow tongue and look for epiglottis. Don't go too deep

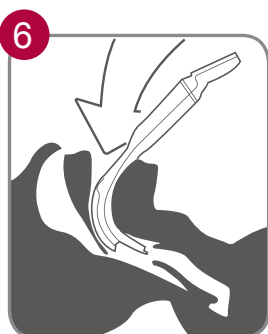

Insert

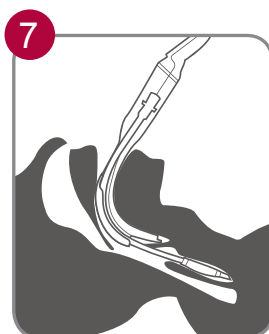

Intubate

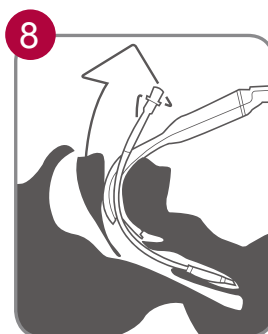

Remove

- Place blade tip in vallecula and visualize vocal cords (for long floppy epiglottis, blade tip may need to be placed under the epiglottis)
- Advance and direct ETT through the vocal cords and to the proper depth in the trachea
- Stabilize/hold the ETT laterally while withdrawing blade from mouth



Select & Attach

- Disconnect blade from display; dispose of blade and clean/disinfect display
- If display becomes soiled with blood/secretions
- Clean with dampened wipes (enzymatic cleaning solution) for 4 minutes
- Disinfect with Sani-Cloth® wipes for 10 minutes replacing the wipes every 2 minutes
- Display is not submersible
- Do not expose opening for electrical connections on bottom of display stem to liquids
- Hold display upright when cleaning