

RWB-250K, 320K, 400K, 500K

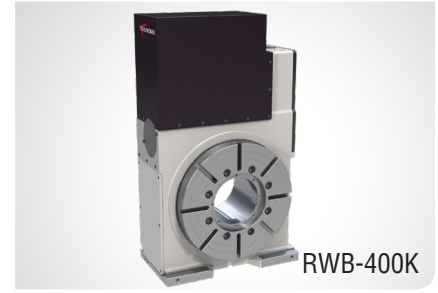

HEAVY DUTY • DUAL DISC HYDRAULIC CLAMPING

The RWB,K-Series rotary tables are designed for use on horizontal machining centers. RWB,K tables utilize a powerful dual disc hydraulic clamping mechanism, and are available with a built-in air/hydraulic booster. RWB,K-Series worm wheels are manufactured as an assembly consisting of the worm wheel, cross roller bearing, and the main spindle, resulting in unsurpassed accuracy.

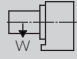

Specifications ►

Dimensions = mm

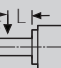
Table Model		RWB-250K	RWB-250K,S	RWB-320K	RWB-320K,S	RWB-400K	RWB-500K	
Table diameter		mm	250	250	320	320	400	500
Center height		mm	160	160	210	210	255	310
Center bore	Nose Diameter	mm	105	95H7	150	130H7	200	220H7
	Thru Diameter	mm	80	71	120	101	160	182
Table T-slot width			12H7	12H7	14H7	14H7	14H7	18H7
Guide block width			18h7					
Servo motor (Fanuc)*			Alpha 8i	Alpha 8is	Alpha 12i	Alpha 22is	Alpha 12i	Alpha 12i
Maximum motor speed		rpm	4,000	4,000	4,000	4,000	4,000	4,000
Speed reduction ratio			1/90	1/45	1/90	1/45	1/90	1/180
Maximum table speed		rpm	44.4	88.9	44.4	88.9	44.4	44.4
Inertia converted into motor shaft		$\times 10^{-3}\text{kg}\cdot\text{m}^2$	1.27	1.0	3.04	3.47	4.63	3.00
Clamp system**			Hydraulic					
Clamp torque @500psi		Nm (ft. lbs.)	1,300 (958)	1,000 (737)	3,100 (2,284)	2,450 (1,806)	5,500 (4,053)	7,600 (5,601)
Indexing accuracy		arc sec.	±7					
Repeatability		arc sec.	±2					
Net Weight		kg (lbs.)	125 (286)	105 (231)	250 (550)	185 (407)	360 (792)	620 (1,364)
Allowable wheel torque		Nm (ft. lbs.)	1,011 (745)	581 (428)	2,127 (1,567)	939 (692)	3,958 (2,917)	3,276 (2,414)
Allowable work inertia		kg·m ²	7.0	2.34	19.2	5.12	36	112
Allowable load when table clamped	 kg (lbs) [w/ tailstock]		175 (385) [250 (550)]	150 (330) [300 (660)]	250 (550) [500 (1,100)]	200 (440) [400 (880)]	300 (660) [600 (1,320)]	600 (1,320)
	 N (lbf)		35,000 (7,700)	19,600 (4,390)	89,000 (19,580)	29,400 (6,586)	109,000 (23,980)	240,000 (52,800)
	 Nm (ft. lbs.)		1,300 (958)	1,000 (737)	3,100 (2,284)	2,450 (1,806)	5,500 (4,053)	7,600 (5,601)
	 Nm (ft. lbs.)		1,500 (1,105)	980 (722)	5,300 (3,906)	3,626 (2,672)	7,800 (5,748)	17,000 (12,529)

* Other motors & RPM available

** Booster optional

Specifications subject to change without notice

Dimensions ▶

Drawings not to scale • Dimensions = mm

RWB-250K

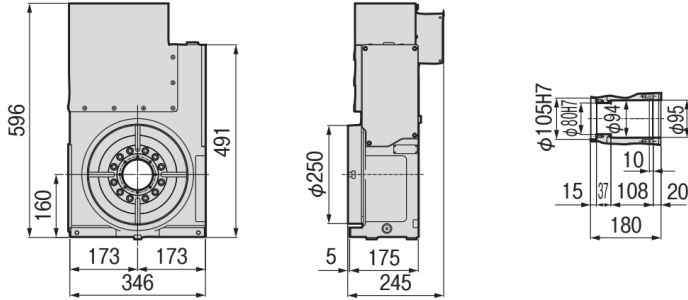

RWB-320K

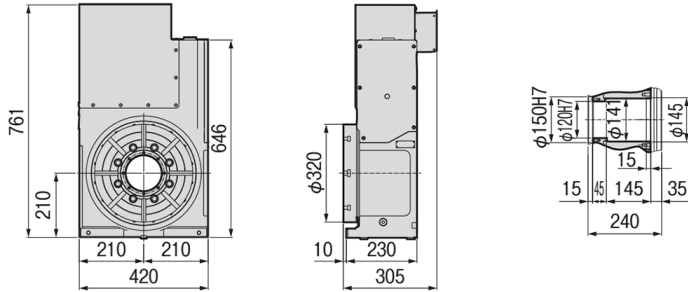

RWB-400K

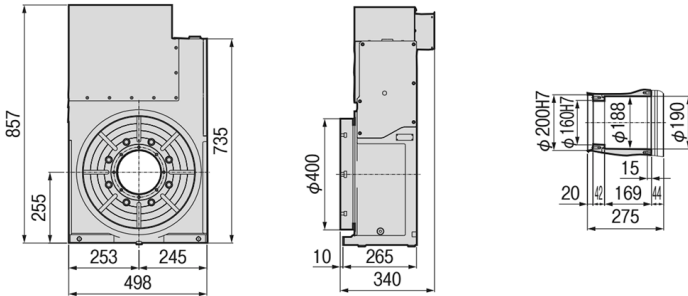

RWB-500K

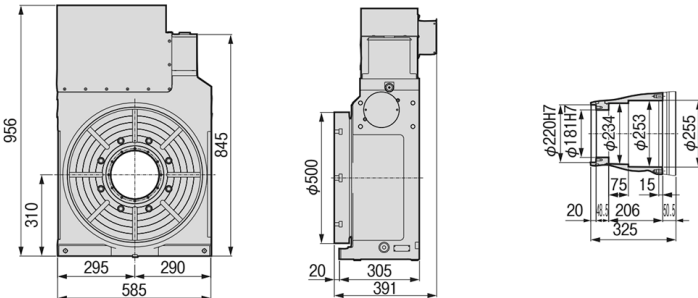

The dimensions above are for tables with a FANUC servo motor. Other motors available (dimensions may increase).

- RWB-400K with capto output



- RWB-400K Custom Swivel Arm
A swivel connector is used to prevent cables from being entangled when the rotary table is mounted on a pallet.



Options & Accessories

TPC NC Controller	p.68
Chucks	p.79
Tailstock	p.81
Support Spindle	p.81
Face Plate	p.83
Encoder / Scale	p.84
Pull Stud Device	p.85
Rotary Joint	p.85
PVC or Steel Cables	p.86

Clamping Block and Bolt ▶

Dimensions = mm

	Type	Q'ty	T-Slot Width	A	B	C	D	E	F	G	H	I	J	K	L	M
RWB-250K	I	4	18	25	12	80	12	33	35	22	21	11	65	40	28	16
RWB-320K	I	4	18	30	15	90	16	31	43	25	21	11	70	46	28	16
RWB-400K	I	4	18	30	15	90	16	31	43	25	21	11	70	46	28	16
RWB-500K	I	4	18	40	20	110	18	42	50	25	21	11	70	46	28	16

Note: When using a machine with a T-slot pitch other than the above, use suitable clamping blocks and bolts that are available on the market, or order custom-made ones from KOMA (opt.)

Type I

