

KAMATICS "KRP" CATALOG
TRACK ROLLERS, CAM FOLLOWERS, AIRFRAME PIVOT BEARINGS



KAMATICS CORPORATION

P. O. Box 3 (1330 Blue Hills Avenue)

Bloomfield, CT USA 06002

860-243-9704, fax 860 243-7993

Kamatics Sales Offices

Please Contact Kamatics for Your Local Representative Worldwide

Bloomfield, CT USA

860-243-9704

fax 860-243-7993





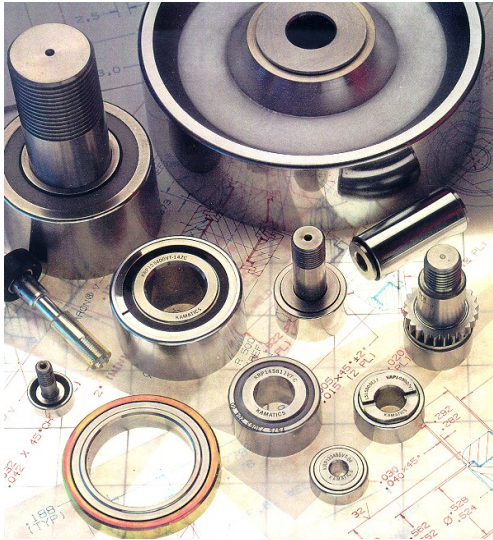





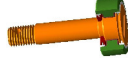
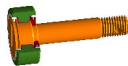

www.kamatics.com

KAMATICS “KRP” Catalog... KARON Lined Track Rollers, Cam Followers & Airframe Pivot Bearings

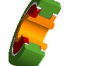

Please review the Kamatics KArOn Design Guide, “KRP” section, and pages 3, 4 & 5 of this catalog for information about the unique Kamatics design approach to solving the more common problems associated with grease lubricated needle, roller and ball bearings. As “KRP” components are manufactured from corrosion resistant materials, a self-lubricating liner, along with a large bearing surface, problems plaguing rolling element bearings such as brinnelling, corrosion and lack of lubrication are non-existent.

See the KArOn Design Guide for liner choices and a description of the liners available. KArOn V is recommended for general high load roller applications. For those applications where operating temperatures exceed +250° F (+120° C) KArOn B or KArOthem T87 is recommended. KArOn F or VS is recommended for applications with low operating pressures, 5000 psi (35 N/mm²) or less. Contact Kamatics engineering for assistance in selecting a liner system for your application.

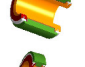
TABLE OF CONTENTS			Page	
Track/Cam Followers (Needle bearing replacements)			English	Metric
	KRP 562 Series	NAS 562 Series Dimensional Equivalent	6	21
	KRP 567 Series	KRP 562 Series with Crowned Outer Race	7	22
Track Rollers (Roller bearing replacements)				
	KRP 502 Series	MS24465 Series Dimensional Equivalent	8	23
	KRP 503 Series	MS24466 Series Dimensional Equivalent	9	24
	KRP 522 Series	KRP 502 Series with Crowned Outer Race	10	25
	KRP 523 Series	Heavy Duty Track Roller Series	11	26
	KRP 527 Series	Self-Aligning Track Roller Series	12	27
Heavy Duty Pivot Bearings (Needle bearing replacements)				
	KRP 505 Series	MS24461 Series Dimensional Equivalent	13	28
	KRP 506 Series	MS24462 Series Dimensional Equivalent	14	29
Airframe Pivot Bearings (Ball bearing replacements)				
	KRP () Series	MS27640 Series Dimensional Equivalent	15	30
	KRP ()A Series	MS27641 Series Dimensional Equivalent	16	31
	KRP ()B Series	MS27642 Series Dimensional Equivalent	17	32
	KRP ()BS Series	MS27648 Series Dimensional Equivalent	18	33
	KRP ()P Series	MS27644 Series Dimensional Equivalent	19	34
	KRPB500 Series	MS27646 Series Dimensional Equivalent	20	35

KAMATICS “KRP”

Track Roller, Cam Follower & Pivot Bearings:

The design and manufacture of self-lubricating track rollers, cam followers and typical airframe pivot bearings was and continues to be pioneered by Kamatics Corporation. It was obvious that there was an unfulfilled need for this type of bearing that would not be subject to the effects of corrosion, brinnelling, ball/roller/needle fracture and difficulty to grease that is common to conventional anti-friction bearings. The need to continually re-lubricate, the manpower required, not being sure that the lubricant ever reached the bearing, was and continues to be a concern. Also, by eliminating the grease requirement, the environment around the bearing remains much cleaner and not subject to the collection of grit, dirt etc. that is also common around greased assemblies. Looking under the wing or at a landing gear of a greased aircraft is enough to make one aware of the potential benefits of non-greased self-lubricated bearings.

Track Rollers & Cam Followers:

For the majority of track roller/cam follower applications the “KRP” design incorporates a KAron liner applied to the OD of the inner race and. Either KAron or PTFE filled Acetal resin is inserted between the side faces of the outer race and thrust members. This provides an additional benefit to the roller by providing a thrust capability not usually found in an anti-friction bearing of the same type. The outer race is made from a hard corrosion resistant stainless steel material, normally Custom 455, 440C or Cronidur 30 stainless steel, and a 17-4 PH stainless steel inner race and thrust member(s). Depending upon the operating conditions, seals are included to minimize the entry of abrasive particles and contaminating fluids. The assembly is then either electron beam welded or swaged to keep the components together as an assembly. **Figure 1** illustrates this Kamatics design approach.

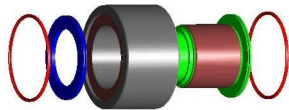

Figure 1 (clevis mounted roller)

The design and load carrying capability of track rollers and cam followers depends heavily on the installation. That is, whether the bearing is installed between a clevis

arrangement or is cantilevered off of structure. Of concern for a cantilevered (studded) roller is determining where the roller will contact the mating track or cam. **Figure 2** shows a studded roller assembly.

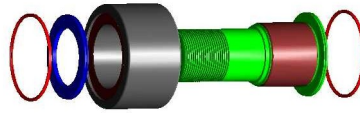

Figure 2. (stud mounted roller)

The worst-case scenario is when the roller contact is at the extreme end of the outer race, away from the threaded end. The bending moment arm is the longest at this point, imparting maximum stress on the stud. This is not a problem unless the stud is not of sufficient size to safely react the implied stress. There are various methods to analyze the bending stresses in a cantilevered roller and this is normally the responsibility of the bearing user. The same concern as to where the outer race will contact the mating surface exists with a clevis-mounted assembly, however, the bending consideration is at a minimum. The concern here is more of track/cam contact and bolt shear stresses. Bolt shear is usually not a major concern as there is double shear involved with a clevis arrangement.

There are ways to minimize the bending concern on a studded roller. One is to incorporate a “crown” radius on the OD of the roller in an attempt to bring the contact point nearer the center of the outer race width. This is the most common approach with anti-friction bearings, however, this ensures that the contact stresses on the track or cam will be high because of the more localized contact area. This is not a problem as long as the stresses are within the material's capabilities.

A second approach to minimizing both the bending and contact stress considerations is the patented Kamatics **self-aligning roller**. This design incorporates a KAron lined spherical inner race that operates against the same hardened outer race material as the more common “KRP” design. The spherical feature allows the roller to conform/align to the mating track/cam surface without the high contact stresses and with a reduced bending moment arm that can be considered to pass through the centerline of the outer race width. **Figure 3** illustrates the self-aligning design.

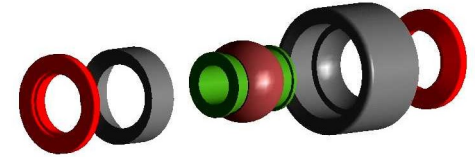

Figure 3. (self-aligning roller)

Extensive testing and field results have shown that a KAron lined track roller will operate successfully for an extended duration at dynamic bearing pressures as high as 20,000 psi (140 mPa). **For most commercial aircraft flap/slat roller applications or similar, by keeping the bearing pressures to a maximum of 12,000 psi (85mPa), the roller can yield in excess of 200,000 revolutions of useful life with liner wear less than 0.004 inches (0.10mm).** As is obvious, if as many as 200,000 revolutions are not required, the bearing pressures can be increased. This is normally the case of military aircraft, where space is small, loads are higher but the number of cycles is lower. Kamatics engineering is available to assist in sizing the roller for any application under consideration.

“KRP” Linkage/Bellcrank Pivot Bearings:

Prior to the Kamatics self-lube KRP design, the typical linkage/bellcrank pivots bearings were mainly limited to ball bearings or greased journal bearings. The “KRP” design for these applications also incorporate a design similar to the track roller/cam follower with an internal self-lube liner, but without the hardened outer race. Because this type of bearing is contained/pressed within a housing the need for a hardened outer race does not normally exist. In “linkage/bellcrank” KRP, the self-lube liner is applied to the ID and side faces of the outer race and the inner race is of sufficient hardness to provide the hard, abrasion-resistant surface necessary for optimum performance. **Figure 4** illustrates this design.

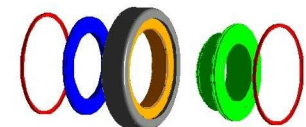

Figure 4 (“KRP” Linkage/Bellcrank Bearing)

Table 8 of the Kamatics KAron Design Guide offers some recommended housing and shoulder dimensions for installation.

This Kamatics “KRP” catalog offers self-lubricated designs that are dimensionally equivalent to many of the more commonly used ball, needle and roller bearings used in industry today. They all feature the benefit of a liner system that is not prone to problems associated with anti-friction bearings. Problems such as race brinnelling, rolling element failure, greasing difficulties (including the requirement to get the grease to the bearing) and the manpower needed to maintain the bearing.

For load-carrying capability of a KRP bearing, calculations based on the projected area concept, described in the Kamatics KAron Design Guide, and similar to that discussed for Kamatics journal bearings should be used. A KRP linkage/bellcrank bearing normally experiences race oscillation as opposed to race rotation for track roller/cam follower bearings. The data in the Kamatics KAron Design Guide, **Table 7** along with **Equations 3 or 4 and 5** can be used to determine potential liner wear.

TABLE 1

Liner	Approximate Physical Properties	Characteristics	Typical Applications
KAron B High Load	Density – 1.51 gm/cc Hardness Rockwell M95 Thickness Range .005 - .060" (.127 – 1.5 mm)	Dynamic operating Pressures to 50,000 psi (345 mPa). Velocities to 3 fpm (1 M/min.) Temp Range –100° to 400° F (-73° to >205°C) SAE AS81820 & SAE AS81934 Qualified	Aircraft controls, landing gears etc. Track rollers. Cam followers Highly loaded linkages. Jet engine controls. Other high loaded demanding, maintenance free applications.
KAron V High Load / Low Friction	Density – 1.36 gm/cc Hardness Rockwell M85 Thickness Range .005 - .060" (.127 – 1.5 mm)	Dynamic operating Pressures to 40,000 psi (276 mPa). Velocities to 10 fpm (3 M/min.) Temp Range –100° to 300° F (-73° to 150°C) Mil-B-8943 Qualified	Track rollers. Cam followers. Marine/naval applications. Aircraft shock struts. Other high loaded, low friction applications.
KAron F Low Friction	Density – 1.36 gm/cc Hardness Rockwell M85 Thickness Range .003" – min. (.076 mm min.)	Rubbing surface is a predominately PTFE enriched outer surface, providing low coefficient of friction at low loads and at low temperatures. The general operating parameters are the same as KAron V. A minimum thickness liner of .003" (.076 mm) can be obtained. Dynamic operating pressures up to 20,000 psi (138 mPa)	Spherical bearings Track rollers. Cam followers Other moderately high loaded, low friction applications
KAron VS Low Friction	Density – 1.56 gm/cc Hardness Rockwell 15X 88 Thickness Range .005 - .060" (.127 – 1.5 mm)	Dynamic operating pressures up to 15,000 psi (103mPa), excellent low temperature friction capabilities. Temp Range –100° to 300° F (-73° to 150°C)	Spherical bearings Track rollers. Cam followers Other moderate loaded, low friction applications
KAtherm T87 High Speed / High Temperature 500°F (260°C)	Density – 1.37 gm/cc Hardness Rockwell M80/90 Thickness Range .005 - .030" (.127 – .75 mm)	Dynamic operating Pressures to 20,000 psi (140 mPa). Velocities to 30 fpm (9 M/min.) Temp Range –100° to 500° F (-73° to 260°C) Designed for SAE AS81819	Formulated for high temperature applications to 500°F (260°C) such as VG bushings, engine linkages, thrust reverser, cam followers, track rollers and helicopter rotor control bearing

Track Rollers, Cam Followers & Airframe Bearing

**KRP 562 Series – Studded, Self-Lubricating,
Track Roller, Cam Follower Bearings
Dimensionally Equivalent to NAS 562 Series**

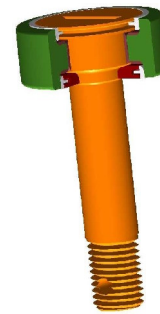
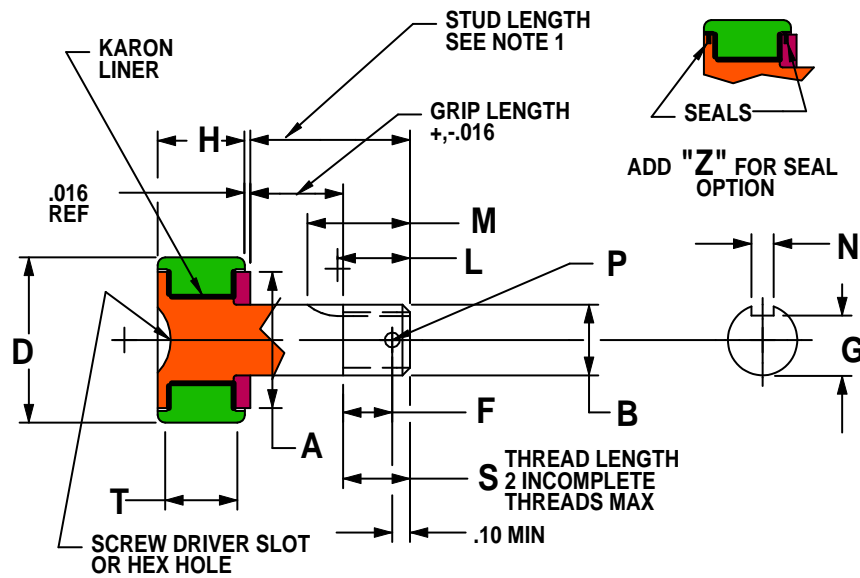

Part Number Example:

KRP 562-6 V T Z A K-16 S D

- KRP** = KAron Track Roller Bearing Prefix
- 562** = Studded Roller Series, Crowned Outer Race
- 6** = .3750 Stud Diameter (Diameter in 1/16 increments)
- V** = KAron V Liner (See Table 1 for liner Options)
- T** = Track Roller Designation (not optional in p/n)
- Z** = Add "Z" for Seal Option
- A** = Add "A" for **NO** Cotter Pin Hole
- K** = Add "K" for Keyway Option
- 16** = 1.000 Stud Grip Length (Length in 1/16 Increments)
- S** = Add "S" for PH13-8MO CRES Stud Option.
- D** = Add "D" for 440C Outer Race Option

For all Sizes:

Radial Play = .0015 to .0035 inches
Axial Play = .005 to .015 inches

KRP562 SERIES	B	D	H	THREAD SIZE UNJF-3A PER MIL-S-8879	F	S	L	M	N	G	P	T	A	RADIAL STATIC LIMIT LOAD (LBS) See Notes 2 & 3
BEARING NUMBER	STUD DIA +.000 -.001	ROLLER OUTER DIA. +.0010 -.0005	ROLLER WIDTH +.005 -.005		DIST TO COTTER PIN HOLE MIN	THREAD LENGTH (REF)	KEYWAY LENGTH +.030 -.000	KEYWAY RUNOUT (REF)	KEY WIDTH +.002 -.002	SLOT DEPTH +.010 -.010	HOLE DIA +.010 -.000	TRACK CONTACT WIDTH MIN	RING DIA (REF)	
KRP562-3	.190	.5000	.281	1900-32	.211	.344	N/A	N/A	N/A	N/A	.070	.230	.40	2925
KRP562-4	.250	.6875	.281	.2500-28	.224	.344	.337	.437	.0635	.2143	.076	.230	.57	3625
KRP562-5	.312	.7500	.344	.3125-24	.234	.359	.327	.437	.0635	.2738	.076	.290	.59	5290
KRP562-6	.375	.8750	.469	.3750-24	.265	.359	.416	.500	.0947	.3236	.106	.380	.72	10000
KRP562-7	.437	1.0000	.531	.4375-20	.283	.422	.452	.562	.0947	.3861	.106	.430	.84	13325
KRP562-8	.500	1.1250	.656	.5000-20	.314	.422	.515	.625	.1260	.4330	.106	.530	.97	18200

STANDARD		LINER	SUFFIX DESIGNATION		
OUTER RACE	STUD & THRUST RING		ADD SUFFIX S TO P/N FOR AMS 5629 (PH13-8MO) Rc 43 MIN (COND H1000 REF), STUD & THRUST RING	ADD SUFFIX D TO P/N FOR AMS 5630 (440C) Rc 55-62 OUTER RACE	ADD SUFFIX Z TO P/N FOR SEAL OPTION (ACETAL RESIN OR NYLON)
AMS 5617 CUSTOM 455 Rc 47 MIN	AMS 5643 (17-4PH) Rc 40 MIN (COND H900 REFERENCE)	KARON (SEE TABLE 1 FOR LINER OPTIONS)			

NOTES:

1. Stud Length = Nominal Grip Length + "S" Thread Length, +.031, -.016
2. Load ratings shown are based on KAron V liner system.
3. Loads shown are based on bearing components only, stud bending not considered.

Track Rollers, Cam Followers & Airframe Bearings

KRP 567 Series – Studded, Self-Lubricating Crowned Outer Race, Track Roller, Cam Follower Bearings Otherwise Dimensionally Equivalent to KRP 562 Series

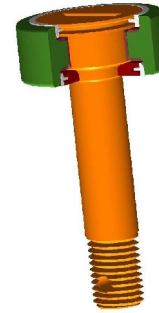
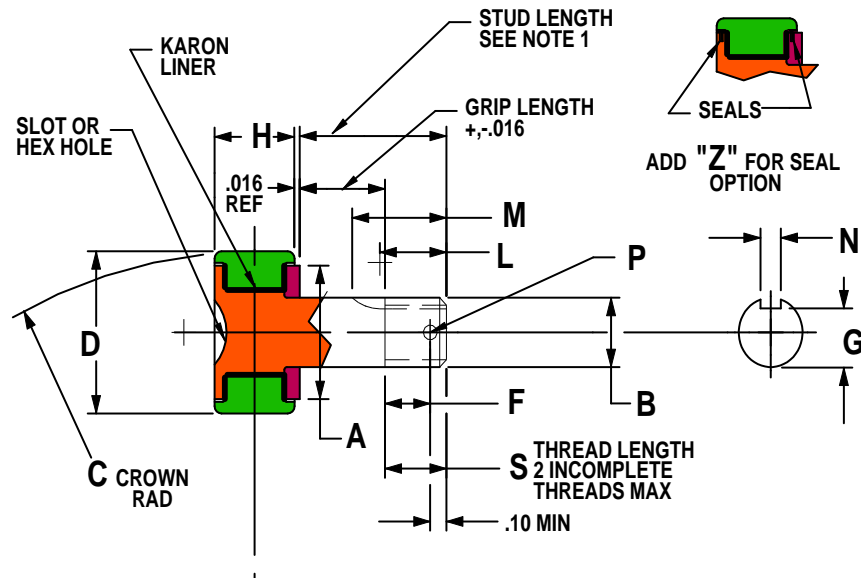

Part Number Example:

KRP 567-6 V T Z A K-16 S D

KRP = KAron Track Roller Bearing Prefix
567 = Studded Roller Series, Crowned Outer Race
-6 = .3750 Stud Diameter (Diameter in 1/16 increments)
V = KAron V Liner (See Table 1 for liner Options)
T = Track Roller Designation (not optional in p/n)
Z = Add "Z" for Seal Option
A = Add "A" for **NO** Cotter Pin Hole Option
K = Add "K" for Keyway Option
-16 = 1.000 Stud Grip Length (Length in 1/16 Increments)
S = Add "S" for PH13-8MO CRES Stud Option.
D = Add "D" for 440C CRES Outer Race Option

For all Sizes:

Radial Play = .0015 to .0035 inches

Axial Play = .005 to .015 inches

KRP567 SERIES	B	D	H	THREAD SIZE UNJF-3A PER MIL-S-8879	F	S	L	M	N	G	P	C	A	RADIAL STATIC LIMIT LOAD (LBS) See Notes 2 & 3
BEARING NUMBER	STUD DIA +.000 -.001	ROLLER OUTER DIA. +.0010 -.0005	ROLLER WIDTH +.005 -.005		DIST TO COTTER PIN HOLE MIN	THREAD LENGTH (REF)	KEYWAY LENGTH +.030 -.000	KEYWAY RUNOUT (REF)	KEY WIDTH +.002 -.002	SLOT DEPTH +.010 -.010	HOLE DIA +.010 -.000	CROWN RADIUS (INCHES) (REF)	RING DIA (REF)	
KRP567-3	.190	.5000	.281	1900-32	.211	.344	N/A	N/A	N/A	N/A	.070	6	.40	2925
KRP567-4	.250	.6875	.281	.2500-28	.224	.344	.337	.437	.0635	.2143	.076	6	.57	3625
KRP567-5	.312	.7500	.344	.3125-24	.234	.359	.327	.437	.0635	.2738	.076	7	.59	5290
KRP567-6	.375	.8750	.469	.3750-24	.265	.359	.416	.500	.0947	.3236	.106	8	.72	10000
KRP567-7	.437	1.0000	.531	.4375-20	.283	.422	.452	.562	.0947	.3861	.106	10	.84	13325
KRP567-8	.500	1.1250	.656	.5000-20	.314	.422	.515	.625	.1260	.4330	.106	12	.97	18200

STANDARD		LINER	SUFFIX DESIGNATION		
OUTER RACE	STUD & THRUST RING		ADD SUFFIX S	ADD SUFFIX D	ADD SUFFIX Z
AMS 5617 CUSTOM 455 Rc 47 MIN	AMS 5643 (17-4PH) Rc 40 MIN (COND H900 REFERENCE)	KARON (SEE TABLE 1 FOR LINER OPTIONS)	TO P/N FOR AMS 5629 (PH13-8MO) COND H1000 Rc 40 MIN, STUD & THRUST RING	TO P/N FOR AMS 5630 (440C) Rc 55 MIN, OUTER RACE	TO P/N FOR SEAL OPTION (ACETAL RESIN OR NYLON)

NOTES:

1. Stud Length = Nominal Grip Length + "S" Thread Length, +.031, -.016
2. Load ratings shown are based on KAron V liner system.
3. Loads shown are based on bearing components only, stud bending is not considered.

Track Rollers, Cam Followers & Airframe Bearings

KRP 502 Series – KArOn Lined, Self-Lubricating, Track Roller, Cam Follower Dimensionally Equivalent to MS24465 Series

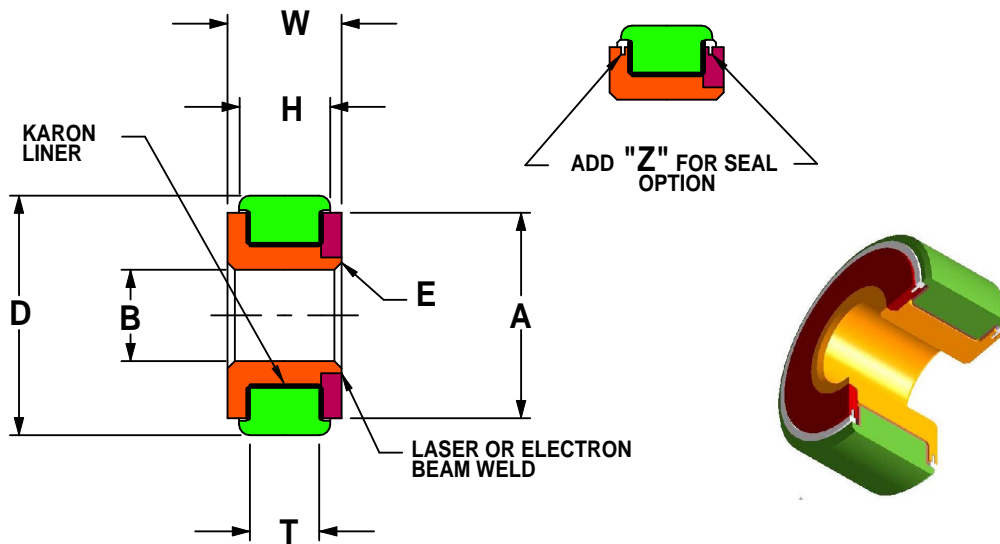

Part Number Example:

KRP 502-06 V I Z D

KRP = KArOn Track Roller Bearing Prefix

502 = Non-Studded Roller Series

-06 = .3750 Bore Diameter (Diameter in 1/16 increments)

V = KArOn V Liner (See Table 1 for liner Options)

I = Track Roller Designation (not optional in p/n)

Z = Add "Z" for Seal Option

D = Add "D" for 440C Outer Race Option

For all Sizes:

Radial Play = .0015 to .0035 inches

Axial Play = .005 to .015 inches

KRP502 SERIES	B	D	W	H	E	A	T	RADIAL STATIC LIMIT LOAD (LBS) See Notes 1 & 2	AXIAL STATIC LIMIT LOAD (LBS)	WEIGHT LBS (REF)
BEARING NUMBER	BORE DIA +.0000 -.0005	ROLLER OUTER DIA. +.0000 -.0010	INNER RACE WIDTH +.000 -.005	OUTER RACE WIDTH +.000 -.005	RADIUS OR 45 DEG CHAMFER TO CLEAR FILLET RAD	THRUST RING DIA (REF)	TRACK CONTACT WIDTH MIN			
KRP502-03	.1900	.7500	.312	.218	.022	.63	.125	4095	2035	.03
KRP502-04	.2500	.8750	.375	.281	.022	.68	.218	6665	2490	.06
KRP502-06	.3750	1.0625	.500	.375	.022	.94	.312	11935	3465	.10
KRP502-08	.5000	1.3125	.625	.500	.032	1.12	.438	20930	4520	.19
KRP502-10	.6250/.6243	1.5000	.750	.625	.032	1.25	.562	29675	5500	.30
KRP502-12	.7500/.7493	1.7500	1.000	.875	.032	1.50	.750	52000	6555	.55
KRP502-14	.8750/.8743	2.0000	1.125	1.000	.032	1.62	.875	76700	7760	.85

OUTER RACE	INNER RACE	THRUST RING	LINER	DESIGNATION	
AMS 5617 CUSTOM 455 Rc 47 MIN	AMS 5643 (17-4PH) Rc 28 MIN (COND H1150 REFERENCE)	AMS 5643 (17-4PH) Rc 28 MIN (COND H1150 REFERENCE)	KARON (SEE TABLE 1 FOR LINER OPTIONS)	ADD SUFFIX Z TO P/N FOR SEAL OPTION (ACETAL RESIN OR NYLON)	ADD SUFFIX D TO PART NUMBER FOR 440C OUTER RACE AMS 5630 Rc 55-62

NOTES:

- Load ratings shown are based on KArOn V liner system.
- Loads shown are based on bearing components only, bolt/pin shear not considered.

Track Rollers, Cam Followers & Airframe Bearings

KRP 503 Series – Self-Lubricating, Airframe, Pivot & Track Roller Bearings

Dimensionally Equivalent to MS24466 Series

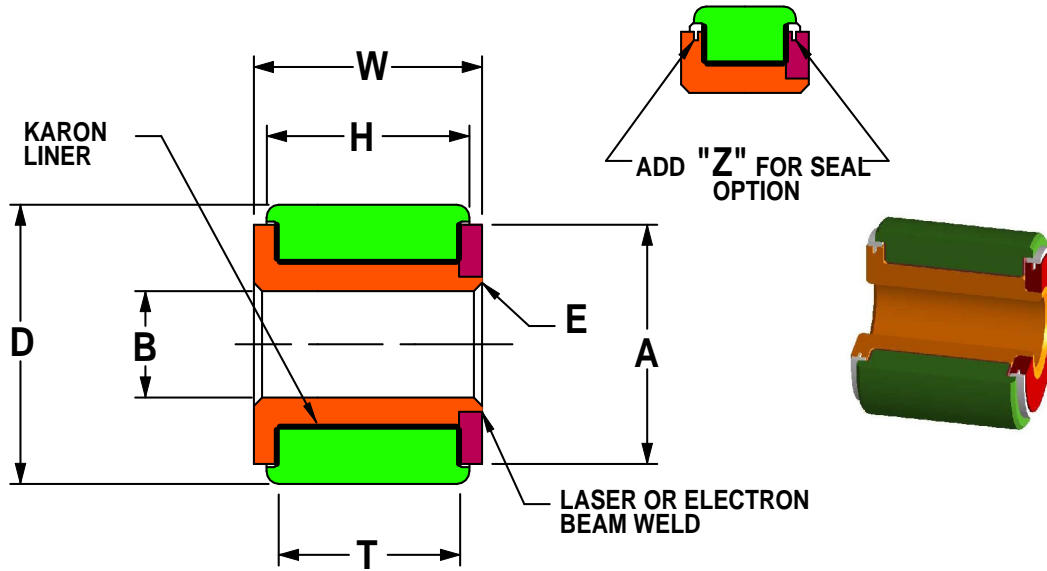

Part Number Example:
KRP 503-06 V I Z D

KRP = KAron Track Roller Bearing Prefix
503 = Non-Studded Roller Series
-06 = .3750 Bore Diameter (Diameter in 1/16 increments)
V = KAron V Liner (See Table 1 for liner Options)
I = Track Roller Designation (not optional in p/n)
Z = Add "Z" for Seal Option
D = Add "D" for 440C Outer Race Option

For all Sizes:
 Radial Play = .0015 to .0035 inches
 Axial Play = .005 to .015 inches

KRP503 SERIES	B	D	W	H	E	A	T	RADIAL STATIC LIMIT LOAD (LBS) See Notes 1 & 2	AXIAL STATIC LIMIT LOAD (LBS)	WEIGHT (LBS)
BEARING NUMBER	BORE DIA +.0000 -.0005	ROLLER OUTER DIA. +.0000 -.0010	INNER RACE WIDTH +.000 -.005	OUTER RACE WIDTH +.000 -.005	RADIUS OR 45 DEG CHAMFER TO CLEAR FILLET RAD	THRUST RING DIA (REF)	TRACK CONTACT WIDTH MIN			
KRP503-06	.3750	1.1250	1.000	.875	.022	.94	.750	30160	3615	.25
KRP503-08	.5000	1.3750	1.250	1.125	.032	1.12	1.000	48750	4670	.45
KRP503-10	.6250/.6243	1.6250	1.500	1.375	.032	1.33	1.125	75565	5650	.74
KRP503-12	.7500/.7493	1.8750	1.750	1.625	.032	1.58	1.375	102375	6630	1.14
KRP503-14	.8750/.8743	2.1250	2.000	1.875	.032	1.72	1.625	141440	7535	1.65

OUTER RACE	INNER RACE	THRUST RING	LINER	DESIGNATION	
AMS 5617 CUSTOM 455 Rc 47 MIN	AMS 5643 (17-4PH) Rc 28 MIN (COND H1150 REFERENCE)	AMS 5643 (17-4PH) Rc 28 MIN (COND H1150 REFERENCE)	KARON (SEE TABLE 1 FOR LINER OPTIONS)	ADD SUFFIX Z TO P/N FOR SEAL OPTION (ACETAL RESIN OR NYLON)	ADD SUFFIX D TO PART NUMBER FOR 440C OUTER RACE AMS 5630 Rc 55-62

- NOTES:**
- Load ratings shown are based on KAron V liner system.
 - Loads shown are based on bearing components only, bolt/pin shear is not considered.

Track Rollers, Cam Followers & Airframe Bearings

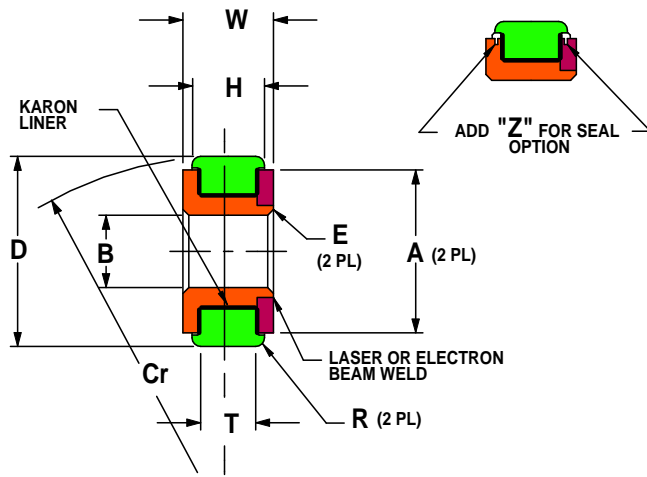

KRP 522 Series – Track Roller, Crowned Outer Race

Similar to KRP 502 Series with Crowned Outer Race

Part Number Example:

KRP 522-06 V I Z D

KRP = KAron Bearing Prefix

522 = Crowned Track Roller Series

-06 = .3750 Bore Diameter (Diameter in 1/16 increments)

V = KAron V Liner (See Table 1 for liner Options)

T = Add "T" for Track Roller (not optional in p/n)

Z = Add "Z" for Seal Option

D = Add "D" for 440C Outer Race Option

KRP522 SERIES	B	D	W	H	E	A	R	Cr	RADIAL STATIC LIMIT LOAD (LBS) See Notes 1 & 2	WEIGHT LBS (REF)
BEARING NUMBER	BORE DIA +.0000 -.0007	ROLLER OUTER DIA. +.0000 -.0010	INNER RACE WIDTH +.000 -.010	OUTER RACE WIDTH +.000 -.015	45 DEG CHAMFER +.010 -.000	THRUST RING DIA (REF)	CORNER RADIUS +.010 -.000	CROWN RADIUS (REF)		
KRP522-03	.1900	.7500	.312	.280	.022	.44	.022	10.0	4800	.03
KRP522-04	.2500	.8750	.375	.345	.022	.52	.022	10.0	7700	.06
KRP522-06	.3750	1.0025	.500	.455	.022	.67	.022	10.0	13000	.10
KRP522-08	.5000	1.3125	.625	.580	.032	.84	.032	12.5	23000	.19
KRP522-10	.6250	1.5000	.750	.705	.032	.95	.032	17.5	35000	.30
KRP522-12	.7500	1.7500	1.000	.950	.032	1.11	.032	25.0	52500	.55
KRP522-14	.8750	2.0000	1.125	1.075	.032	1.22	.032	27.5	66700	.85
KRP522-16	1.0000	2.1250	1.187	1.137	.032	1.63	.032	30.0	82400	1.30
KRP522-20	1.2500	2.2500	1.250	1.200	.032	1.75	.032	30.0	104000	1.75
KRP522-24	1.5000	3.0010/2.9988	1.500	1.440	.032	2.00	.032	60.0	145000	2.20
KRP522-28	1.7500	3.4385/3.4363	1.500	1.440	.032	2.28	.032	60.0	163500	2.90
KRP522-32	2.0000	3.8760/3.8738	1.500	1.440	.032	2.56	.032	60.0	181500	3.60
KRP522-36	2.2500	4.3135/4.3113	1.500	1.440	.032	2.86	.032	60.0	207000	4.50
KRP522-40	2.5000	4.7510/4.7488	1.500	1.440	.032	3.11	.032	60.0	226500	5.40
KRP522-44	2.7500	5.0010/4.9988	1.500	1.440	.032	3.34	.032	60.0	236000	5.60

OUTER RACE	INNER RACE	THRUST RING	LINER	DESIGNATION	
AMS 5617 CUSTOM 455 Rc 47 MIN	AMS 5643 (17-4PH) Rc 28 MIN (COND H1150 REFERENCE)	AMS 5643 (17-4PH) Rc 28 MIN (COND H1150 REFERENCE)	KARON (SEE TABLE 1 FOR LINER OPTIONS)	ADD SUFFIX "Z" TO P/N FOR SEAL OPTION (ACETAL RESIN OR NYLON)	ADD SUFFIX "D" TO PART NUMBER FOR 440C OUTER RACE AMS 5630 Rc 55-62

NOTES:

1. Load ratings shown are based on KAron V liner system.
2. Loads shown are based on bearing components only, bolt/pin shear is not considered.
3. For all Sizes:
Radial Play = .0015 to .0035 inches
Axial Play = .005 to .015 inches

Track Rollers, Cam Followers & Airframe Bearings

KRP 523 Series – Self-Lubricating, Airframe, Pivot & Track Roller Bearings Typical Aircraft High Load Flap Track Roller Series

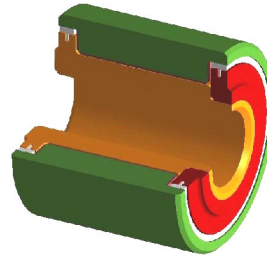
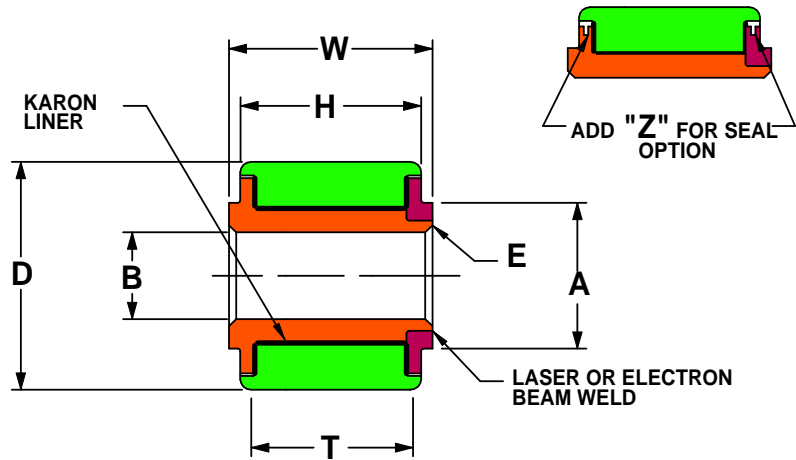

Part Number Example:

KRP 523-06 V I Z D

KRP = KAron Track Roller Bearing Prefix

523 = Non-Studded Roller Series

-06 = .3750 Bore Diameter (Diameter in 1/16 increments)

V = KAron V Liner (See Table 1 for liner Options)

T = Track Roller Designation (not optional in p/n)

Z = Add "Z" for Seal Option

D = Add "D" for 440C Outer Race Option

For all Sizes:

Radial Play = .0015 to .0035 inches

Axial Play = .005 to .015 inches

KRP503 SERIES	B	D	W	H	E	A	T	RADIAL STATIC LIMIT LOAD (LBS) See Notes 1 & 2	WEIGHT LBS (REF)
BEARING NUMBER	BORE DIA	ROLLER OUTER DIA.	INNER RACE WIDTH	OUTER RACE WIDTH	RADIUS OR 45 DEG CHAMFER	THRUST RING DIA (REF)	TRACK CONTACT WIDTH MIN		
	+ .0000 - .0005	+ .000 - .001	+ .000 - .005	+ .000 - .005	+ .010 - .000				
KRP523-04	.2500	.8750	.750	.710	.022	.52	.58	16500	.12
KRP523-06	.3750	1.1250	1.000	.940	.022	.67	.75	29000	.25
KRP523-08	.5000	1.3750	1.250	1.190	.032	.84	1.00	50000	.45
KRP523-10	.6250	1.6250	1.500	1.440	.032	.95	1.13	76000	.74
KRP523-12	.7500	1.8750	1.750	1.690	.032	1.11	1.38	98000	1.14
KRP523-14	.8750	2.1250	2.000	1.940	.032	1.22	1.63	127000	1.65
KRP523-16	1.0000	2.3750	2.250	2.190	.032	1.58	1.88	173000	2.30
KRP523-20	1.2500	2.7500	2.500	2.440	.032	1.63	2.03	223000	3.30
KRP523-24	1.5000	2.9988/3.0010	2.750	2.690	.032	2.00	2.28	283000	4.10
KRP523-28	1.7500	3.4363/3.4385	3.000	2.940	.032	2.28	2.63	350000	5.80
KRP523-32	2.0000	3.8738/3.8760	3.000	2.940	.032	2.56	2.63	388000	7.30

OUTER RACE	INNER RACE	THRUST RING	LINER	DESIGNATION	
AMS 5617 CUSTOM 455 Rc 47 MIN	AMS 5643 (17-4PH) Rc 28 MIN (COND H1150 REFERENCE)	AMS 5643 (17-4PH) Rc 28 MIN (COND H1150 REFERENCE)	KARON (SEE TABLE 1 FOR LINER OPTIONS)	ADD SUFFIX Z TO P/N FOR SEAL OPTION (ACETAL RESIN OR NYLON)	ADD SUFFIX D TO PART NUMBER FOR 440C OUTER RACE AMS 5630 Rc 55-62

NOTES:

1. Load ratings shown are based on KAron V liner system.
2. Loads shown are based on bearing components only, bolt/pin shear is not considered.

Track Rollers, Cam Followers & Airframe Bearings

KRP 527 Series – KAron Lined, Self-Aligning, Self-Lubricating, Track Roller/ Cam Follower Series

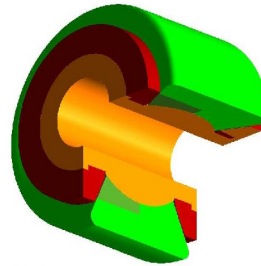
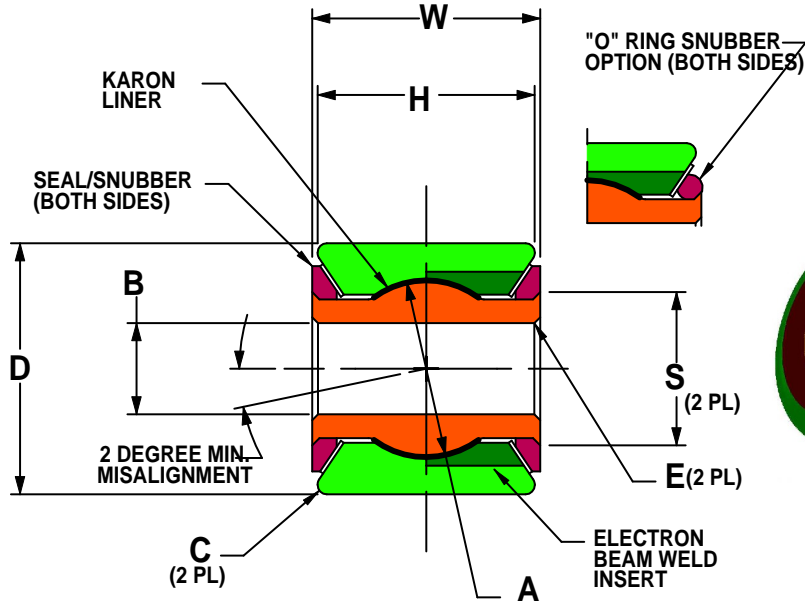

Part Number Example:
KRP 527 08 V I

KRP = KAron Bearing Prefix
527 = Self-Aligning Roller Series
-08 = .5000 Bore Diameter (Diameter in 1/16 increments)
V = KAron V Liner (See Table 1 for liner Options)
T = Track Roller Application

For all Sizes:
 Radial Play = .0030 inches maximum
 Rotational Torque (no-load) = 2 inch-pounds maximum

KRP527 SERIES	B	D	W	H	E	A	C	S	RADIAL STATIC LIMIT LOAD (LBS) See Notes 1 & 2	WEIGHT LBS (REF)
BEARING NUMBER	BORE DIA +.0000 -.0007	ROLLER OUTER DIA. +.0000 -.0010	INNER RACE WIDTH +.000 -.010	OUTER RACE WIDTH +.000 -.005	45 DEG CHAMFER +.010 -.000	INNER RACE SPHERICAL DIA (REF)	CORNER RADIUS (MINIMUM)	CLAMP-UP DIAMETER (REF)		
KRP527-04	.2500	.8750	.750	.656	.022	.610	.020	.52	12600	.12
KRP527-06	.3750	1.1250	1.000	.940	.022	.800	.040	.67	20100	.25
KRP527-08	.5000	1.3750	1.250	1.190	.032	.968	.050	.84	27500	.45
KRP527-10	.6250	1.6250	1.500	1.440	.032	1.200	.050	.91	49000	.74
KRP527-12	.7500	1.8750	1.750	1.690	.032	1.375	.050	1.11	52400	1.14
KRP527-14	.8750	2.1250	2.000	1.940	.032	1.620	.050	1.22	71300	1.65

OUTER RACE & INSERT	INNER RACE	SEAL / SNUBBER	LINER
AMS 5617 CUSTOM 455 Rc 47 MIN	AMS 5643 (17-4PH) Rc 28 MIN (COND H1150 REFERENCE)	PTFE / ELASTOMER	KARON (SEE TABLE 1 FOR LINER OPTIONS)

NOTES:

- Load ratings shown are based on KAron V liner system.
- Loads shown are based on bearing components only, bolt/pin shear is not considered.

Track Rollers, Cam Followers & Airframe Bearings

KRP 505 Series – Self-Lubricating Airframe, Pivot & Track Roller Bearings

Dimensionally Equivalent to MS24461 Series

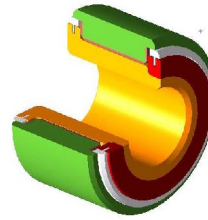
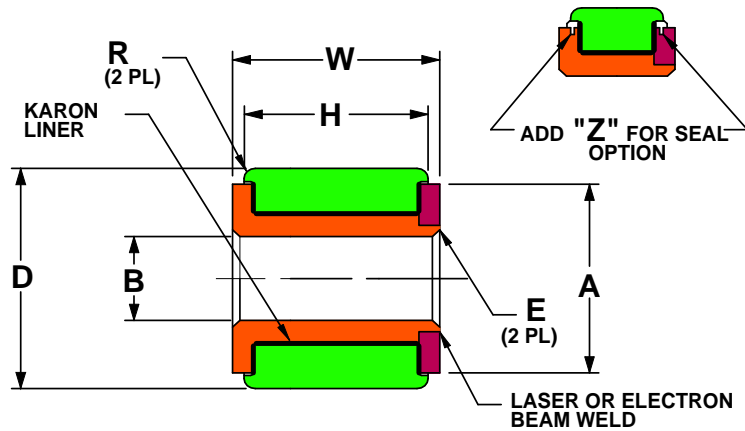

Part Number Example:

KRP 505-06 V I Z D P

KRP = Karon Bearing Prefix

505 = Airframe/Pivot/Roller Series

-06 = .3750 Bore Diameter (Diameter in 1/16 increments)

V = Karon V Liner (See Table 1 for liner Options)

T = Add "T" for Track Roller (Custom 455 Outer Race) Option

Z = Add "Z" for Seal Option

D = Add "D" for 440C Outer Race Option

P = Add "P" for OD Cadmium Plate Option (per QQ-P-416

Type II, Class 2)

KRP505 SERIES	B	D	W	H	E	A	R	RADIAL STATIC LIMIT LOAD (LBS) See Notes 1 & 2	AXIAL STATIC LIMIT LOAD (LBS)	WEIGHT LBS (REF)
BEARING NUMBER	BORE DIA +.0000 -.0005	ROLLER OUTER DIA. +.0000 -.0005	INNER RACE WIDTH +.000 -.005	OUTER RACE WIDTH +.000 -.005	RADIUS OR 45 DEG CHAMFER TO CLEAR FILLET RAD	THRUST RING DIA (REF)	RADIUS OR 45 DEG CHAMFER +.010 -.000			
KRP505-03	.1900	.6875	.312	.218	.022	.53	.022	4055	2035	.03
KRP505-04	.2500	.7500	.375	.281	.022	.61	.022	6665	2485	.04
KRP505-05	.3125	.8125	.437	.344	.022	.64	.022	9165	2940	.05
KRP505-06	.3750	.8750	.562	.469	.022	.72	.022	15445	3465	.07
KRP505-07	.4375	.9375	.625	.531	.032	.78	.032	19890	3920	.09
KRP505-08	.5000	1.1250	.750	.656	.032	.97	.032	28665	4520	.17
KRP505-09	.5625/.5618	1.1875	.875	.781	.032	1.03	.032	35570	4965	.22
KRP505-10	.6250/.6243	1.2500	1.000	.906	.032	1.09	.032	42640	5425	.27
KRP505-12	.7500/.7493	1.3750	1.125	1.000	.032	1.22	.032	56810	6405	.34
KRP505-14	.8750/.8743	1.6250	1.250	1.125	.032	1.47	.032	73710	7385	.53
KRP505-16	1.0000/.9993	1.7500	1.250	1.125	.032	1.55	.032	85315	8440	.58
KRP505-20	1.2500/1.2493	2.0000/1.9994	1.250	1.049	.032	1.80	.032	102375	10325	.69
KRP505-24	1.5000/1.4993	2.2500/2.2494	1.250	1.049	.032	2.05	.032	119440	12210	.79
KRP505-28	1.7500/1.7493	2.5000/2.4994	1.250	1.049	.032	2.30	.032	136500	14090	.90
KRP505-32	2.0000/1.9993	2.7500/2.7494	1.250	1.049	.032	2.55	.032	153565	15975	1.00
KRP505-36	2.2500/2.2493	3.0000/2.9994	1.250	1.049	.032	2.80	.032	170625	17890	1.11
KRP505-40	2.5000/2.4993	3.2500/3.2492	1.250	1.049	.032	3.05	.032	187690	19745	1.22
KRP505-44	2.7500/2.7493	3.5000/3.4992	1.250	1.049	.032	3.30	.032	204750	21630	1.33
KRP505-48	3.0000/2.9993	3.7500/3.7492	1.250	1.049	.032	3.55	.032	221915	23510	1.43
KRP505-52	3.2500/3.2492	4.0000/3.9992	1.250	1.049	.032	3.80	.032	238875	25470	1.50

OUTER RACE	INNER RACE	THRUST RING	LINER	DESIGNATION		
AMS 5643 (17-4PH) Rc 28 MIN (COND H1150 REFERENCE)	AMS 5643 (17-4PH) Rc 40 MIN (COND H900 REFERENCE)	AMS 5643 (17-4PH) Rc 40 MIN (COND H900 REFERENCE)	KARON (SEE TABLE 1 FOR LINER OPTIONS)	ADD SUFFIX "Z" TO P/N FOR SEAL OPTION (ACETAL RESIN OR NYLON)	ADD SUFFIX "T" FOR TRACK ROLLER OPTION AMS 5617 OUTER RACE CUSTOM 455 Rc 47 MIN	ADD SUFFIX "D" TO PART NUMBER FOR 440C OUTER RACE AMS 5630 Rc 55-62

NOTES:

- Load ratings shown are based on Karon V liner system.
- Loads shown are based on bearing components only, bolt/pin shear is not considered.
- For all Sizes:
Radial Play = .0015 to .0035 inches
Axial Play = .005 to .015 inches

Track Rollers, Cam Followers & Airframe Bearings

KRP 506 Series –Self-Lubricating, Airframe, Pivot & Track Roller Bearings

Dimensionally Equivalent to MS24462 Series

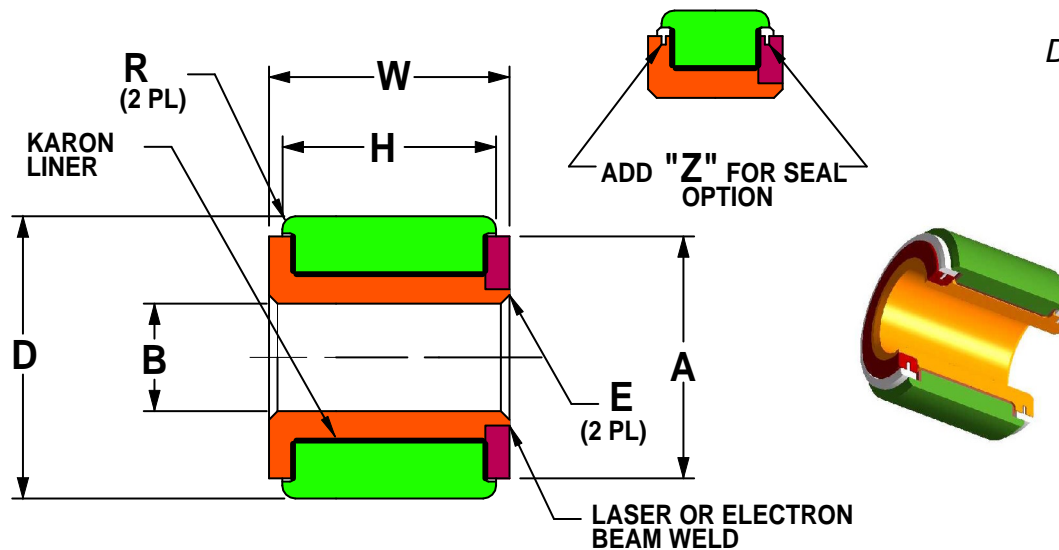

Part Number Example:

KRP 506-06 V I Z D P

KRP = KAron Bearing Prefix

506 = Airframe/Pivot/Roller Series

-06 = .3750 Bore Diameter (Diameter in 1/16 increments)

V = KAron V Liner (See Table 1 for liner Options)

T = Add "T" for Track Roller (Custom 455 Outer Race) Option

Z = Add "Z" for Seal Option

D = Add "D" for 440C Outer Race Option

P = Add "P" for OD Cadmium Plate Option (per QQ-P-416 Type II, Class 2)

For all Sizes:

Radial Play = .0015 to .0035 inches

Axial Play = .005 to .015 inches

KRP506 SERIES	B	D	W	H	E	A	R	RADIAL STATIC LIMIT LOAD (LBS) See Notes 1 & 2	AXIAL STATIC LIMIT LOAD (LBS)	WEIGHT LBS (REF)
BEARING NUMBER	BORE DIA	ROLLER OUTER DIA.	INNER RACE WIDTH	OUTER RACE WIDTH	RADIUS OR 45 DEG CHAMFER TO CLEAR FILLET RAD	THRUST RING DIA (REF)	RADIUS OR 45 DEG CHAMFER			
	+ .0000 - .0005	+ .0000 - .0010	+ .000 - .005	+ .000 - .005	+ .010 - .000					
KRP506-03	.1900	.6250	.625	.500	.022	.51	.022	11600	2035	.05
KRP506-04	.2500	.6250	.562	.500	.022	.51	.022	10580	2335	.04
KRP506-05	.3125	.6875	.625	.500	.022	.57	.022	14255	2790	.06
KRP506-06	.3750	.7500	.812	.750	.022	.63	.022	22425	3315	.08
KRP506-07	.4375	.8125	.875	.750	.022	.69	.022	26210	3695	.09
KRP506-08	.5000	1.0000	.875	.750	.032	.88	.032	30890	4370	.14
KRP506-10	.6250	1.1250	.875	.750	.032	1.00	.032	36970	5350	.16
KRP506-12	.7500	1.2500	1.125	1.000	.032	1.12	.032	48670	6255	.25
KRP506-14	.8750	1.3750	1.125	1.000	.032	1.25	.032	56785	7235	.28
KRP506-16	1.0000	1.5000	1.125	1.000	.032	1.38	.032	72760	8140	.31
KRP506-20	1.2500	1.8750	1.375	1.250	.032	1.75	.032	111815	10025	.61

OUTER RACE	INNER RACE	THRUST RING	LINER	DESIGNATION		
AMS 5643 (17-4PH) Rc 28 MIN (COND H1150 REFERENCE)	AMS 5643 (17-4PH) Rc 40 MIN (COND H900 REFERENCE)	AMS 5643 (17-4PH) Rc 40 MIN (COND H900 REFERENCE)	KARON (SEE TABLE 1 FOR LINER OPTIONS)	ADD SUFFIX "Z" TO P/N FOR SEAL OPTION (ACETAL RESIN OR NYLON)	ADD SUFFIX "T" FOR TRACK ROLLER OPTION AMS 5617 OUTER RACE CUSTOM 455 Rc 47 MIN	ADD SUFFIX "D" TO PART NUMBER FOR 440C OUTER RACE AMS 5630 Rc 55-62

NOTES:

1. Load ratings shown are based on KAron V liner system.

2. Loads shown are based on bearing components only, bolt/pin shear is not considered.

Rev D May 5, 2004 : KRP506-()VT OPTION WAS 440C

Rev G Dec 23, 2008: MS24462 was MS24461

Track Rollers, Cam Followers & Airframe Bearings

KRP () Series – Self-Lubricating Airframe/Pivot Bearings

Dimensionally Equivalent to MS27640 Series

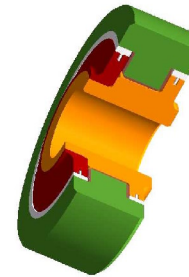
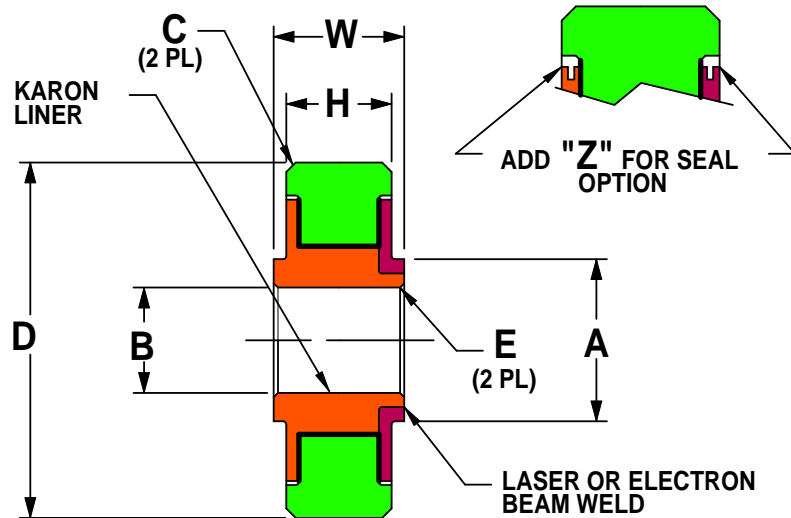

Part Number Example:

KRP 06 V Z P

KRP = KAron Bearing Prefix

-06 = .3750 Bore Diameter (Diameter in 1/16 increments)

V = KAron V Liner (See Table 1 for liner Options)

Z = Add "Z" for Seal Option

P = Add "P" for OD Cadmium Plate Option (per QQ-P-416 Type II, Class 2)

For all Sizes:

Radial Play = .0015 to .0035 inches

Axial Play = .005 to .015 inches

KRP () SERIES	B	D	W	H	E	A	C	RADIAL STATIC LIMIT LOAD (LBS) See Notes 1 & 2	AXIAL STATIC LIMIT LOAD (LBS)	WEIGHT LBS (REF)
BEARING NUMBER	BORE DIA +.0000 -.0005	ROLLER OUTER DIA. +.0000 -.0005	INNER RACE WIDTH +.000 -.005	OUTER RACE WIDTH +.000 -.005	45 DEG CHAMFER +.015 -.000	THRUST RING DIA (REF)	45 DEG CHAMFER +.015 -.000			
KRP03	.1900	.7774	.297	.270	.005	.35	.022	3410	2035	.04
KRP04	.2500	.9014	.484	.335	.005	.41	.032	5860	2490	.07
KRP05	.3125	1.2500	.558	.375	.015	.47	.032	7640	2940	.14
KRP06	.3750	1.4375	.620	.469	.015	.59	.032	13425	3768	.23
KRP08	.5000	1.6875	.620	.500	.015	.77	.044	17680	5200	.31
KRP10	.6250	1.9375	.620	.500	.015	.85	.044	22100	6200	.38

OUTER RACE	INNER RACE	THRUST RING	LINER	DESIGNATION
AMS 5643 (17-4PH) Rc 28 MIN (COND H1150 REFERENCE)	AMS 5643 (17-4PH) Rc 40 MIN (COND H900 REFERENCE)	AMS 5643 (17-4PH) Rc 40 MIN (COND H900 REFERENCE)	KARON (SEE TABLE 1 FOR LINER OPTIONS)	ADD SUFFIX "Z" TO P/N FOR SEAL OPTION (ACETAL RESIN OR NYLON)

NOTES:

- Load ratings shown are based on KAron V liner system.
- Loads shown are based on bearing components only, bolt/pin shear is not considered.

Track Rollers, Cam Followers & Airframe Bearings

KRP ()A Series – Self-Lubricating, Narrow Airframe/Pivot Bearings Dimensionally Equivalent to MS27641 Series

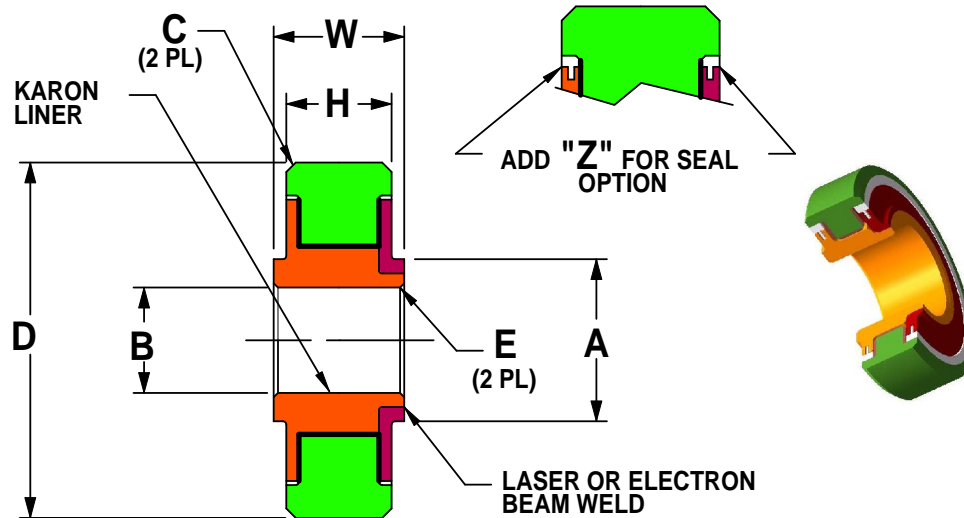

Part Number Example:
KRP 06 A V Z P

KRP = KArOn Bearing Prefix
-06 = .3750 Bore Diameter (Diameter in 1/16 increments)
A = Narrow Airframe/Pivot Bearing
V = KArOn V Liner (See Table 1 for liner Options)
Z = Add "Z" for Seal Option
P = Add "P" for OD Cadmium Plate Option (per QQ-P-416 Type II, Class 2)

For all Sizes:
 Radial Play = .0015 to .0035 inches
 Axial Play = .005 to .015 inches

KRP() A SERIES	B	D	W	H	E	A	C	RADIAL STATIC LIMIT LOAD (LBS) See Notes 1 & 2	AXIAL STATIC LIMIT LOAD (LBS)	WEIGHT LBS (REF)
BEARING NUMBER	BORE DIA +.0000 -.0005	ROLLER OUTER DIA. +.0000 -.0005	INNER RACE WIDTH +.000 -.005	OUTER RACE WIDTH +.000 -.005	45 DEG CHAMFER +.015 -.000	THRUST RING DIA (REF)	45 DEG CHAMFER +.015 -.000			
KRP03A	.1900	.6250	.297	.234	.005	.35	.016	2275	2035	.02
KRP04A	.2500	.7500	.281	.219	.005	.41	.016	2400	2290	.03
KRP05A	.3125	.8125	.297	.234	.015	.47	.016	3055	2940	.03
KRP06A	.3750	.8750	.313	.250	.015	.54	.016	4210	3460	.04
KRP08A	.5000	1.1250	.375	.313	.015	.66	.016	7720	4370	.08
KRP10A	.6250	1.3750	.406	.344	.015	.79	.032	11300	5350	.12
KRP12A	.7500	1.6250	.437	.375	.015	.92	.032	14950	6255	.19
KRP16A	1.0000	2.0000	.500	.438	.015	1.24	.032	24990	8440	.31
KRP20A	1.2500	2.2500	.500	.438	.015	1.48	.032	29820	10320	.36

OUTER RACE	INNER RACE	THRUST RING	LINER	DESIGNATION
AMS 5643 (17-4PH) Rc 28 MIN (COND H1150 REFERENCE)	AMS 5643 (17-4PH) Rc 40 MIN (COND H900 REFERENCE)	AMS 5643 (17-4PH) Rc 40 MIN (COND H900 REFERENCE)	KARON (SEE TABLE 1 FOR LINER OPTIONS)	ADD SUFFIX "Z" TO P/N FOR SEAL OPTION (ACETAL RESIN OR NYLON)

- NOTES:**
- Load ratings shown are based on KArOn V liner system.
 - Loads shown are based on bearing components only, bolt/pin shear is not considered.

Track Rollers, Cam Followers & Airframe Bearings

KRP ()B Series – Self-Lubricating, Narrow Airframe/Pivot Bearings Dimensionally Equivalent to MS27642 Series

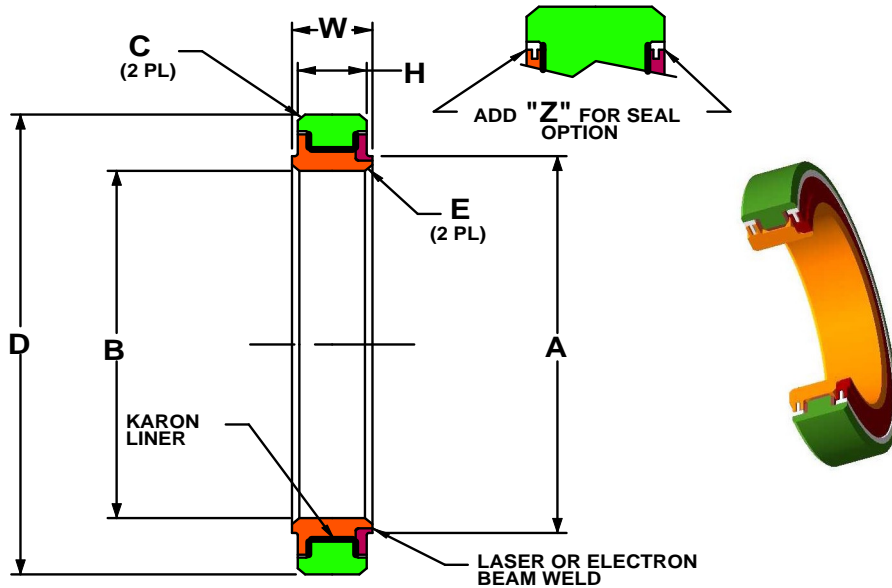

Part Number Example:
KRP 16 B V Z P

KRP = KAron Bearing Prefix
16 = 1.000 Bore Diameter (Diameter in 1/16 increments)
B = Airframe/Pivot Bearing
V = KAron V Liner (See Table 1 for liner Options)
Z = Add "Z" for Seal Option
P = Add "P" for OD Cadmium Plate Option (per QQ-P-416 Type II, Class 2)

For all Sizes:
 Radial Play = .0015 to .0035 inches
 Axial Play = .005 to .015 inches

KRP() B SERIES	B	D	W	H	E	A	C	RADIAL STATIC LIMIT LOAD (LBS) See Notes 1 & 2	AXIAL STATIC LIMIT LOAD (LBS)	WEIGHT LBS (REF)
BEARING NUMBER	BORE DIA +.0000 -.0010	ROLLER OUTER DIA. +.0000 -.0010	INNER RACE WIDTH +.000 -.005	OUTER RACE WIDTH +.000 -.005	45 DEG CHAMFER +.015 -.000	THRUST RING DIA (REF)	45 DEG CHAMFER +.015 -.000			
KRP16B	1.0000	1.7500	.437	.375	.024	1.20	.024	19500	8290	.18
KRP21B	1.3130	2.0625	.437	.375	.024	1.51	.024	24540	10625	.23
KRP23B	1.4380	2.1875	.437	.375	.024	1.64	.024	26650	11605	.24
KRP25B	1.5630	2.3125	.437	.375	.024	1.76	.024	28600	12510	.26
KRP29B	1.8130	2.5625	.437	.375	.024	2.01	.024	32665	14395	.29
KRP33B	2.0630	2.8125	.437	.375	.024	2.26	.024	36725	16280	.33
KRP37B	2.3130	3.0625	.437	.375	.024	2.51	.024	40790	18160	.36
KRP47B	2.9380	3.8750	.531	.469	.039	3.14	.039	55110	22910	.73
KRP49B	3.0630	4.0000	.531	.469	.039	3.26	.039	57215	23815	.75

OUTER RACE	INNER RACE	THRUST RING	LINER	DESIGNATION
AMS 5643 (17-4PH) Rc 28 MIN (COND H1150 REFERENCE)	AMS 5643 (17-4PH) Rc 40 MIN (COND H900 REFERENCE)	AMS 5643 (17-4PH) Rc 40 MIN (COND H900 REFERENCE)	KARON (SEE TABLE 1 FOR LINER OPTIONS)	ADD SUFFIX "Z" TO P/N FOR SEAL OPTION (ACETAL RESIN OR NYLON)

- NOTES:**
- Load ratings shown are based on KAron V liner system.
 - Loads shown are based on bearing components only, bolt/pin shear is not considered.

Track Rollers, Cam Followers & Airframe Bearings

KRP()BS Series – Self-Lubricating, Torque Tube, Airframe, Pivot Bearings Dimensionally Equivalent to MS27648 Series

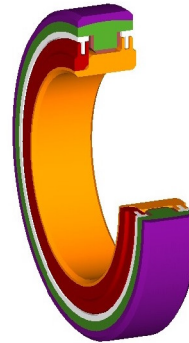
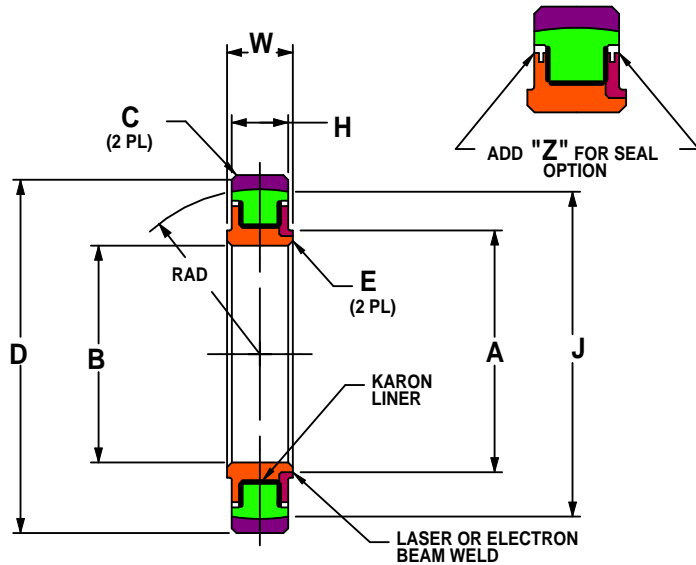

Part Number Example:
KRP 23 BS V Z P

KRP = KAron Bearing Prefix
23 = 1.4380 Bore Diameter (Diameter in 1/16 increments)
BS = Self-aligning Torque Tube Bearing
V = KAron V Liner (See Table 1 for liner Options)
Z = Add "Z" for Seal Option
P = Add "P" for OD Cadmium Plate Option (per QQ-P-416 Type II, Class 2)

For all Sizes:
 Radial Play = .0015 to .0035 inches
 Axial Play = .005 to .015 inches

KRP()BS SERIES	B	D	W	H	E	A	C	J	RADIAL STATIC LIMIT LOAD (LBS) See Notes 1 & 2	AXIAL STATIC LIMIT LOAD (LBS)	WEIGHT LBS (REF)
BEARING NUMBER	BORE DIA +.0000 -.0010	ROLLER OUTER DIA. +.0000 -.0010	INNER RACE WIDTH +.000 -.005	OUTER RACE WIDTH +.000 -.005	45 DEG CHAMFER +.015 -.000	THRUST RING DIA (REF)	45 DEG CHAMFER +.015 -.000	TO SHARP CORNER (REF)			
KRP16BS	1.0000	1.9375	.437	.375	.024	1.20	.024	1.710	19500	8290	.22
KRP21BS	1.3130	2.2500	.437	.375	.024	1.51	.024	2.030	24540	10625	.27
KRP23BS	1.4380	2.3750	.437	.375	.024	1.64	.024	2.155	26650	11605	.29
KRP25BS	1.5630	2.5000	.437	.375	.024	1.76	.024	2.282	28600	12510	.32
KRP29BS	1.8130	2.7500	.437	.375	.024	2.01	.024	2.535	32665	14395	.35
KRP33BS	2.0630	3.0000	.437	.375	.024	2.26	.024	2.790	36725	16280	.40
KRP37BS	2.3130	3.2500	.437	.375	.024	2.51	.024	3.040	40970	18160	.43
KRP47BS	2.9380	4.1250	.531	.469	.039	3.14	.039	3.845	55110	22910	.88
KRP48BS	3.0000	4.2500	.531	.469	.039	3.26	.039	3.970	57215	23815	.91
KRP49BS	3.0630	4.2500	.531	.469	.039	3.32	.039	3.970	57215	23815	.91

OUTER RACE	INNER RACE	OUTER RACE SELF-ALIGNING RING	THRUST RING	LINER	DESIGNATION
AMS 5643 (17-4PH) Rc 40 MIN (COND H900 REFERENCE)	AMS 5643 (17-4PH) Rc 40 MIN (COND H900 REFERENCE)	AMS 5643 (17-4PH) Rc 28 MIN (COND H1150 REFERENCE)	AMS 5643 (17-4PH) Rc 40 MIN (COND H900 REFERENCE)	KARON (SEE TABLE 1 FOR LINER OPTIONS)	ADD SUFFIX "Z" TO P/N FOR SEAL OPTION (ACETAL RESIN OR NYLON)

- NOTES:**
- Load ratings shown are based on KAron V liner system.
 - Loads shown are based on bearing components only, bolt/pin shear is not considered.

Track Rollers, Cam Followers & Airframe Bearings

KRP ()P Series – KArOn Lined, Self-Lubricating, Wide Airframe/Pivot Bearings Dimensionally Equivalent to MS27644 Series

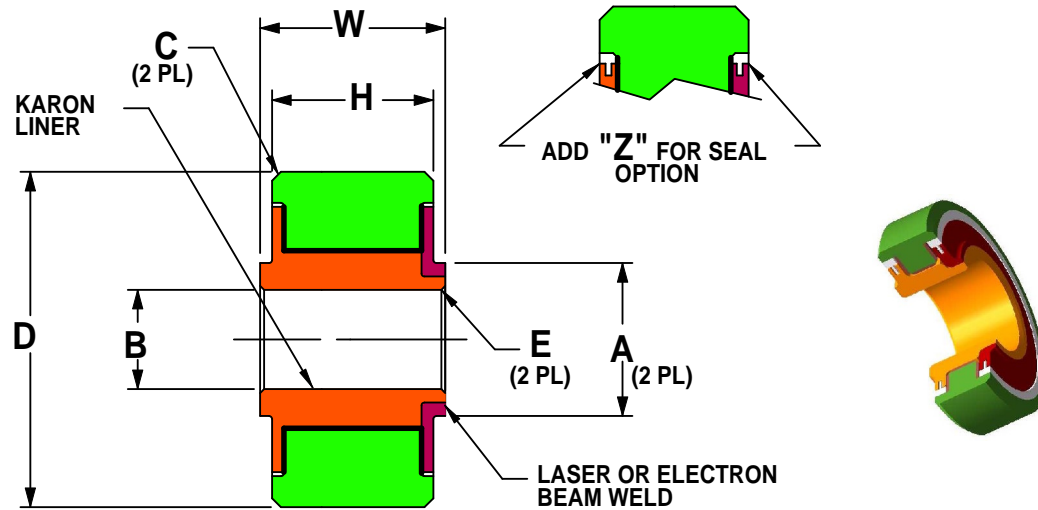

Part Number Example:
KRP 06 P V Z P

KRP = KArOn Bearing Prefix
-06 = .3750 Bore Diameter (Diameter in 1/16 increments)
P = Wide Airframe/Pivot Bearing
V = KArOn V Liner (See Table 1 for liner Options)
Z = Add "Z" for Seal Option
P = Add "P" for OD Cadmium Plate Option (per QQ-P-416 Type II, Class 2)

For all Sizes:
 Radial Play = .0015 to .0035 inches
 Axial Play = .005 to .015 inches

KRP() P SERIES	B	D	W	H	E	A	C	RADIAL STATIC LIMIT LOAD (LBS) See Notes 1 & 2	AXIAL STATIC LIMIT LOAD (LBS)	WEIGHT LBS (REF)
BEARING NUMBER	BORE DIA +.0000 -.0005	ROLLER OUTER DIA. +.0000 -.0005	INNER RACE WIDTH +.000 -.005	OUTER RACE WIDTH +.000 -.005	45 DEG CHAMFER +.015 -.000	THRUST RING DIA (REF)	45 DEG CHAMFER +.015 -.000			
KRP03P	.1900	.7774	.495	.473	.005	.350	.018	6825	2025	.06
KRP04P	.2500	.9014	.620	.491	.005	.410	.032	9330	2500	.09
KRP05P	.3125	1.2500	.745	.687	.015	.500	.032	16380	3240	.24
KRP06P	.3750	1.4375	.870	.794	.015	.625	.032	26800	3770	.35
KRP08P	.5000	1.6875	.932	.856	.015	.735	.044	42250	4675	.55
KRP10P	.6250	1.9375	.995	.920	.015	.890	.044	58500	5650	.75

OUTER RACE	INNER RACE	THRUST RING	LINER	DESIGNATION
AMS 5643 (17-4PH) Rc 28 MIN (COND H1150 REFERENCE)	AMS 5643 (17-4PH) Rc 40 MIN (COND H900 REFERENCE)	AMS 5643 (17-4PH) Rc 40 MIN (COND H900 REFERENCE)	KARON (SEE TABLE 1 FOR LINER OPTIONS)	ADD SUFFIX "Z" TO P/N FOR SEAL OPTION (ACETAL RESIN OR NYLON)

NOTES:

- Load ratings shown are based on KArOn V liner system.
- Loads shown are based on bearing components only, bolt/pin shear is not considered.

Track Rollers, Cam Followers & Airframe Bearings

KRPB500 Series – Self-Lubricating, Narrow Airframe, Pivot Bearings Dimensionally Equivalent to MS27646 Series

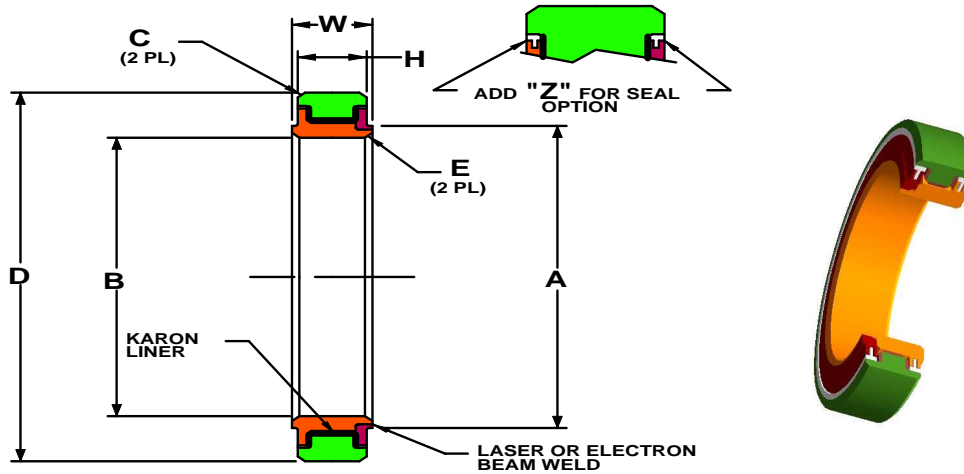

Part Number Example:
KRPB 540 V Z P

KRPB = KAron Bearing Prefix
540 = .875 Bore Diameter (Diameter in 1/16 increments)
V = KAron V Liner (See Table 1 for liner Options)
Z = Add "Z" for Seal Option
P = Add "P" for OD Cadmium Plate Option (per QQ-P-416 Type II, Class 2)

For all Sizes:
 Radial Play = .0015 to .0035 inches
 Axial Play = .005 to .015 inches

KRPB500 SERIES	B	D	W	H	E	A	C	RADIAL STATIC LIMIT LOAD (LBS) See Notes 1 & 2	AXIAL STATIC LIMIT LOAD (LBS)	WEIGHT LBS (REF)
BEARING NUMBER	BORE DIA +.0007 -.0007	ROLLER OUTER DIA. +.0000 -.0010	INNER RACE WIDTH +.000 -.005	OUTER RACE WIDTH +.000 -.005	45 DEG CHAMFER +.020 -.000	THRUST RING DIA (REF)	45 DEG CHAMFER +.020 -.000			
KRPB538	.6250	1.0625	.281	.250	.015	.80	.015	6240	5275	.04
KRPB539	.7500	1.1875	.281	.250	.015	.91	.015	7020	6030	.05
KRPB540	.8750	1.3125	.281	.250	.015	1.04	.015	8110	7235	.06
KRPB541	1.0625	1.5000	.281	.250	.015	1.22	.015	9515	8590	.07
KRPB542	1.3125	1.7500	.281	.250	.015	1.47	.015	11460	10475	.08
KRPB543	1.5625	2.0000	.281	.250	.015	1.72	.015	13415	12360	.09
KRPB544	1.8135/1.8115	2.2500/2.2485	.281	.250	.015	1.97	.015	15360	14240	.10
KRPB545	2.0635/2.0615	2.6250/2.6235	.281	.250	.015	2.28	.015	17940	16425	.16
KRPB546	2.3135/2.3115	2.8750/2.8735	.281	.250	.015	2.55	.015	19890	18310	.17

OUTER RACE	INNER RACE	THRUST RING	LINER	DESIGNATION
AMS 5643 (17-4PH) Rc 28 MIN (COND H1150 REFERENCE)	AMS 5643 (17-4PH) Rc 40 MIN (COND H900 REFERENCE)	AMS 5643 (17-4PH) Rc 40 MIN (COND H900 REFERENCE)	KARON (SEE TABLE 1 FOR LINER OPTIONS)	ADD SUFFIX "Z" TO P/N FOR SEAL OPTION (ACETAL RESIN OR NYLON)

- NOTES:**
- Load ratings shown are based on KAron V liner system.
 - Loads shown are based on bearing components only, bolt/pin shear is not considered.

Track Rollers, Cam Followers & Airframe Bearings

KRP 562 Series – Studded, Self-Lubricating, Track Roller, Cam Follower Bearings Dimensionally Equivalent to NAS 562 Series

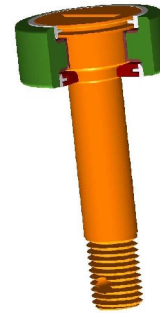
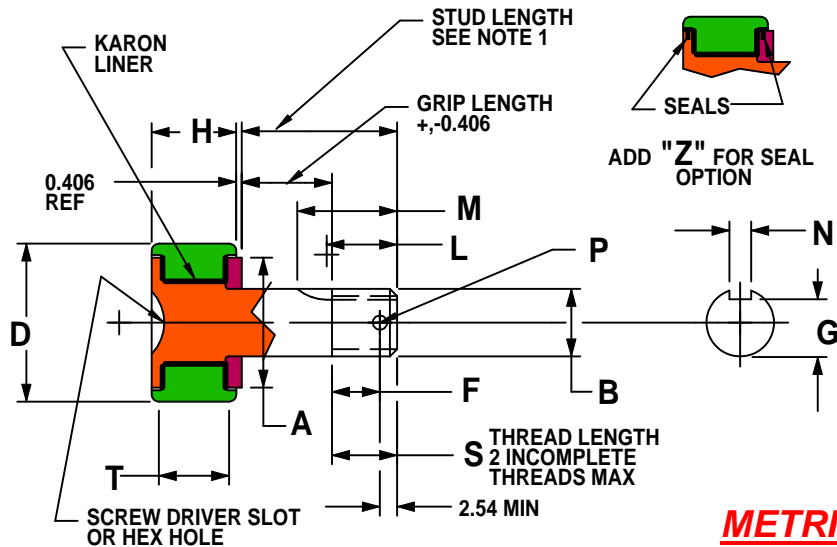

Part Number Example:

KRP 562-6 V T Z A K-16 S D

- KRP** = KArOn Track Roller Bearing Prefix
- 562** = Studded Roller Series, Crowned Outer Race
- 6** = 9.525 Stud Diameter (Diameter in 1/16 inch increments)
- V** = KArOn V Liner (See Table 1 for liner Options)
- T** = Track Roller Designation (not optional in p/n)
- Z** = Add "Z" for Seal Option
- A** = Add "A" for **NO** Cotter Pin Hole
- K** = Add "K" for Keyway Option
- 16** = 25.400 mm Stud Grip Length (Length in 1/16 inch Increments)
- S** = Add "S" for PH13-8MO CRES Stud Option.
- D** = Add "D" for 440C Outer Race Option

For all Sizes:

Radial Play = 0.038 to 0.089 mm
Axial Play = 0.130 to 0.381 mm

All Dimensions in Millimeters

KRP562 SERIES	B	D	H	THREAD SIZE UNJF-3A PER MIL-S-8879 (inches)	F	S	L	M	N	G	P	T	A	RADIAL STATIC LIMIT LOAD (KN) See Notes 2 & 3
BEARING NUMBER	STUD DIA +0.000 -0.025	ROLLER OUTER DIA. +0.025 -0.013	ROLLER WIDTH +0.127 -0.127		DIST TO COTTER PIN HOLE MIN	THREAD LENGTH (REF)	KEYWAY LENGTH +0.762 -0.000	KEYWAY RUNOUT (REF)	KEY WIDTH +0.051 -0.051	SLOT DEPTH +0.254 -0.254	HOLE DIA +0.254 -0.000	TRACK CONTACT WIDTH MIN	RING DIA (REF)	
KRP562-3	4.826	12.700	7.137	1900-32	5.359	8.738	N/A	N/A	N/A	N/A	1.778	5.842	10.16	13.0
KRP562-4	6.350	17.463	7.137	.2500-28	5.690	8.738	8.560	11.100	1.613	5.443	1.930	5.842	14.48	16.1
KRP562-5	7.925	19.050	8.738	.3125-24	5.944	9.119	8.306	11.100	1.613	6.955	1.930	7.366	14.99	23.5
KRP562-6	9.525	22.225	11.913	.3750-24	6.731	9.119	10.566	12.700	2.405	8.219	2.692	9.652	18.29	44.5
KRP562-7	11.100	25.400	13.487	.4375-20	7.188	10.719	11.481	14.275	2.405	9.807	2.692	10.922	21.34	59.3
KRP562-8	12.700	28.575	16.662	.5000-20	7.976	10.719	13.081	15.875	3.200	10.998	2.692	13.462	24.64	81.0

STANDARD		LINER	SUFFIX DESIGNATION		
OUTER RACE	STUD & THRUST RING		ADD SUFFIX S	ADD SUFFIX D	ADD SUFFIX Z
AMS 5617 CUSTOM 455 Rc 47 MIN	AMS 5643 (17-4PH) Rc 40 MIN (COND H900 REFERENCE)	KARON (SEE TABLE 1 FOR LINER OPTIONS)	TO P/N FOR AMS 5629 (PH13-8MO) Rc 43 MIN (COND H1000 REF), STUD & THRUST RING	TO P/N FOR AMS 5630 (440C) Rc 55-62 OUTER RACE	TO P/N FOR SEAL OPTION (ACETAL RESIN OR NYLON)

NOTES:

1. Stud Length = Nominal Grip Length + "S" Thread Length, +0.787, -0.406
2. Load ratings shown are based on KArOn V liner system.
3. Loads shown are based on bearing components only, stud bending not considered.

Track Rollers, Cam Followers & Airframe Bearings

KRP 567 Series – Studded, Self-Lubricating Crowned Outer Race, Track Roller, Cam Follower Bearings

Otherwise Dimensionally Equivalent to KRP 562 Series

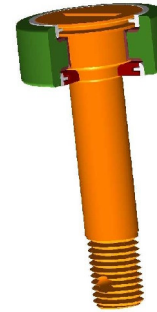
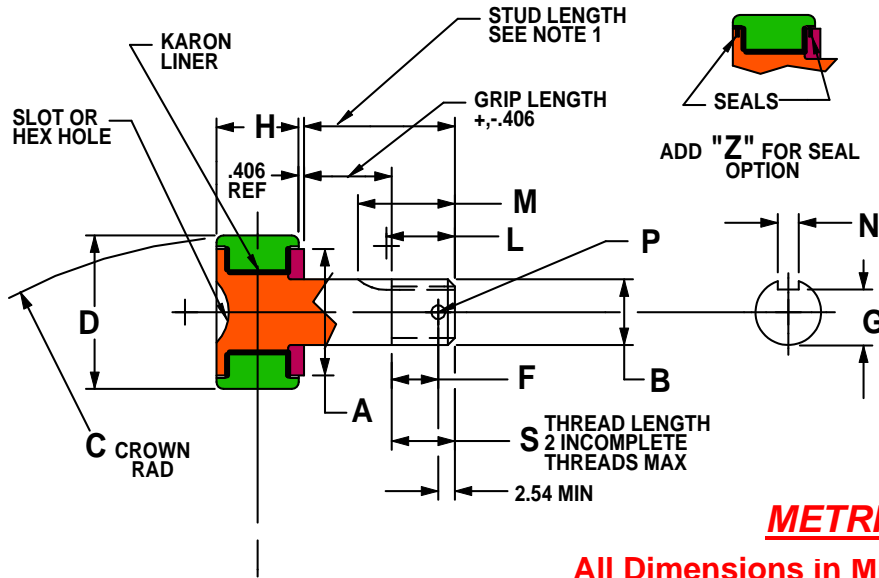

Part Number Example:

KRP 567-6 V I Z A K-16 S D

KRP = Karon Track Roller Bearing Prefix

567 = Studded Roller Series, Crowned Outer Race

-6 = 9.525 mm Stud Diameter (Diameter in 1/16 inch increments)

V = Karon V Liner (See Table 1 for liner Options)

T = Track Roller Designation (not optional in p/n)

Z = Add "Z" for Seal Option

A = Add "A" for **NO** Cotter Pin Hole Option

K = Add "K" for Keyway Option

-16 = 25.400 mm Stud Grip Length (Length in 1/16 inch Increments)

S = Add "S" for PH13-8MO CRES Stud Option.

D = Add "D" for 440C CRES Outer Race Option

For all Sizes:

Radial Play = 0.038 to 0.089 mm

Axial Play = 0.130 to 0.381 mm

KRP567 SERIES	B	D	H	THREAD SIZE UNJF-3A PER MIL-S-8879 (INCHES)	F	S	L	M	N	G	P	C	A	RADIAL STATIC LIMIT LOAD (KN) See Notes 2 & 3
BEARING NUMBER	STUD DIA +.000 -.025	ROLLER OUTER DIA. +.025 -.013	ROLLER WIDTH +.127 -.127		DIST TO COTTER PIN HOLE MIN	THREAD LENGTH (REF)	KEYWAY LENGTH +.762 -.000	KEYWAY RUNOUT (REF)	KEY WIDTH +.051 -.051	SLOT DEPTH +.254 -.254	HOLE DIA +.254 -.000	CROWN RADIUS (REF)	RING DIA (REF)	
KRP567-3	4.826	12.700	7.137	1900-32	5.359	8.738	N/A	N/A	N/A	N/A	1.778	152	10.16	13.0
KRP567-4	6.350	17.463	7.137	.2500-28	5.690	8.738	8.560	11.100	1.613	5.443	1.930	152	14.48	16.1
KRP567-5	7.925	19.050	8.738	.3125-24	5.944	9.119	8.306	11.100	1.613	6.955	1.930	178	14.99	23.5
KRP567-6	9.525	22.225	11.913	.3750-24	6.731	9.119	10.566	12.700	2.405	8.219	2.692	203	18.29	44.5
KRP567-7	11.100	25.400	13.487	.4375-20	7.188	10.719	11.481	14.275	2.405	9.807	2.692	254	21.34	59.3
KRP567-8	12.700	28.575	16.662	.5000-20	7.976	10.719	13.081	15.875	3.200	10.998	2.692	305	24.64	81.0

STANDARD		LINER	SUFFIX DESIGNATION		
OUTER RACE	STUD & THRUST RING		ADD SUFFIX S	ADD SUFFIX D	ADD SUFFIX Z
AMS 5617 CUSTOM 455 Rc 47 MIN	AMS 5643 (17-4PH) Rc 40 MIN (COND H900 REFERENCE)	KARON (SEE TABLE 1 FOR LINER OPTIONS)	TO P/N FOR AMS 5629 (PH13-8MO) Rc 43 MIN (COND H1000 REF), STUD & THRUST RING	TO P/N FOR AMS 5630 (440C) Rc 55-62 OUTER RACE	TO P/N FOR SEAL OPTION (ACETAL RESIN OR NYLON)

NOTES:

1. Stud Length = Nominal Grip Length + "S" Thread Length, +0.787, -0.406
2. Load ratings shown are based on Karon V liner system.
3. Loads shown are based on bearing components only, stud bending not considered.

Track Rollers, Cam Followers & Airframe Bearings

KRP 502 Series – KArOn Lined, Self-Lubricating, Track Roller, Cam Follower

Dimensionally Equivalent to MS24465 Series

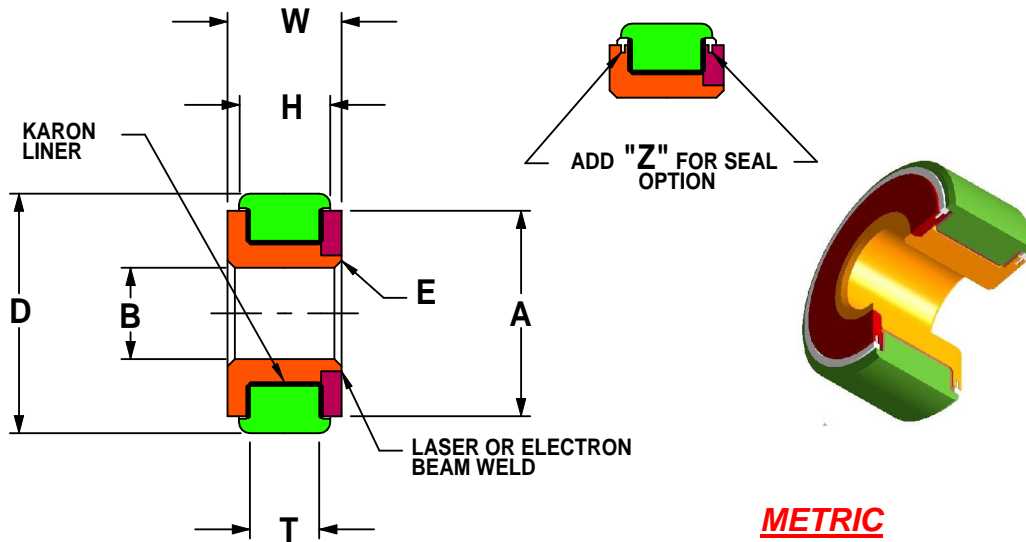

Part Number Example:

KRP 502-06 V I Z D

- KRP** = KArOn Track Roller Bearing Prefix
- 502** = Non-Studded Roller Series
- 06** = 9.525 mm Bore Diameter (Diameter in 1/16 inch increments)
- V** = KArOn V Liner (See Table 1 for liner Options)
- I** = Track Roller Designation (not optional in p/n)
- Z** = Add "Z" for Seal Option
- D** = Add "D" for 440C Outer Race Option

For all Sizes:

Radial Play = 0.038 to 0.089 mm
 Axial Play = 0.130 to 0.381 mm

METRIC
 All Dimensions in Millimeters

KRP502 SERIES	B	D	W	H	E	A	T	RADIAL STATIC LIMIT LOAD (KN) See Notes 1 & 2	AXIAL STATIC LIMIT KN (LBS)	WEIGHT LBS (KG)
BEARING NUMBER	BORE DIA +0.00 - .013	ROLLER OUTER DIA. +0.00 -.025	INNER RACE WIDTH +0.00 -.127	OUTER RACE WIDTH +0.00 -.127	RADIUS OR 45 DEG CHAMFER TO CLEAR FILLET RAD	THRUST RING DIA (REF)	TRACK CONTACT WIDTH MIN			
KRP502-03	4.826	19.050	7.925	5.537	0.559	16.00	3.175	18.2	9.1	0.014
KRP502-04	6.350	22.225	9.525	7.137	0.559	17.27	5.537	29.6	11.1	0.027
KRP502-06	9.525	26.988	12.700	9.525	0.559	23.88	7.925	53.1	15.4	0.045
KRP502-08	12.700	33.338	15.875	12.700	0.813	28.45	11.125	93.1	20.1	0.086
KRP502-10	15.875/15.857	38.100	19.050	15.875	0.813	31.75	14.275	132.0	24.5	0.136
KRP502-12	19.050/19.032	44.450	25.400	22.225	0.813	38.10	19.050	231.3	29.2	0.249
KRP502-14	22.225/22.207	50.800	28.575	25.400	0.813	41.15	22.225	341.2	34.5	0.385

OUTER RACE	INNER RACE	THRUST RING	LINER	DESIGNATION	
AMS 5617 CUSTOM 455 Rc 47 MIN	AMS 5643 (17-4PH) Rc 28 MIN (COND H1150 REFERENCE)	AMS 5643 (17-4PH) Rc 28 MIN (COND H1150 REFERENCE)	KARON (SEE TABLE 1 FOR LINER OPTIONS)	ADD SUFFIX Z TO P/N FOR SEAL OPTION (ACETAL RESIN OR NYLON)	ADD SUFFIX D TO PART NUMBER FOR 440C OUTER RACE AMS 5630 Rc 55-62

NOTES:

1. Load ratings shown are based on KArOn V liner system.
2. Loads shown are based on bearing components only, bolt/pin shear not considered.

Track Rollers, Cam Followers & Airframe Bearings

KRP 503 Series – Self-Lubricating, Airframe, Pivot & Track Roller Bearings

Dimensionally Equivalent to MS24466 Series

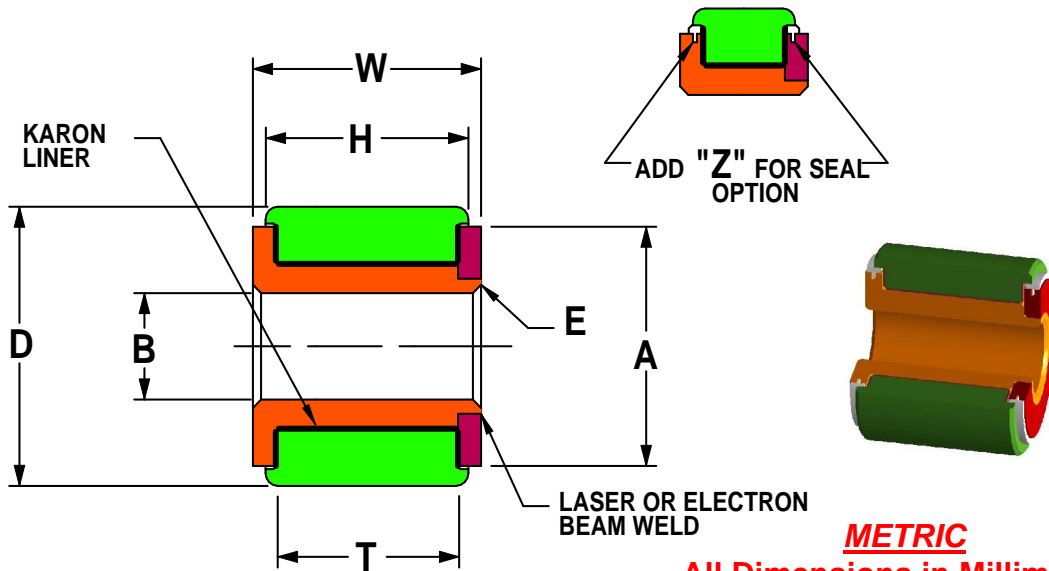

METRIC
All Dimensions in Millimeters

Part Number Example:

KRP 503-06 V I Z D

- KRP** = KAron Track Roller Bearing Prefix
- 503** = Non-Studded Roller Series
- 06** = 9.525 mm Bore Diameter (Diameter in 1/16 inch increments)
- V** = KAron V Liner (See Table 1 for liner Options)
- T** = Track Roller Designation (not optional in p/n)
- Z** = Add "Z" for Seal Option
- D** = Add "D" for 440C Outer Race Option

For all Sizes:

Radial Play = 0.038 to 0.089 mm

Axial Play = 0.130 to 0.381 mm

KRP503 SERIES	B	D	W	H	E	A	T	RADIAL STATIC LIMIT LOAD (KN) See Notes 1 & 2	AXIAL STATIC LIMIT LOAD (KN)	WEIGHT LBS (KG)
BEARING NUMBER	BORE DIA	ROLLER OUTER DIA.	INNER RACE WIDTH	OUTER RACE WIDTH	RADIUS OR 45 DEG CHAMFER TO CLEAR FILLET RAD	THRUST RING DIA (REF)	TRACK CONTACT WIDTH MIN			
	+0.000 -0.013	+0.000 -0.025	+0.000 -0.127	+0.000 -0.127						
KRP503-06	9.525	28.575	25.400	22.225	0.559	23.88	19.050	134.2	16.1	0.113
KRP503-08	12.700	34.925	31.750	28.575	0.813	28.45	25.400	216.9	20.8	0.204
KRP503-10	15.875/15.857	41.275	38.100	34.925	0.813	33.78	28.575	336.1	25.1	0.336
KRP503-12	19.050/19.032	47.625	44.450	41.275	0.813	40.13	34.925	455.4	29.5	0.517
KRP503-14	22.225/22.207	53.975	50.800	47.625	0.813	43.69	41.275	629.2	33.5	0.748

OUTER RACE	INNER RACE	THRUST RING	LINER	DESIGNATION	
AMS 5617 CUSTOM 455 Rc 47 MIN	AMS 5643 (17-4PH) Rc 28 MIN (COND H1150 REFERENCE)	AMS 5643 (17-4PH) Rc 28 MIN (COND H1150 REFERENCE)	KARON (SEE TABLE 1 FOR LINER OPTIONS)	ADD SUFFIX Z TO P/N FOR SEAL OPTION (ACETAL RESIN OR NYLON)	ADD SUFFIX D TO PART NUMBER FOR 440C OUTER RACE AMS 5630 Rc 55-62

NOTES:

1. Load ratings shown are based on KAron V liner system.
2. Loads shown are based on bearing components only, bolt/pin shear is not considered.

Track Rollers, Cam Followers & Airframe Bearings

KRP 522 Series – Track Roller, Crowned Outer Race Similar to KRP 502 Series with Crowned Outer Race

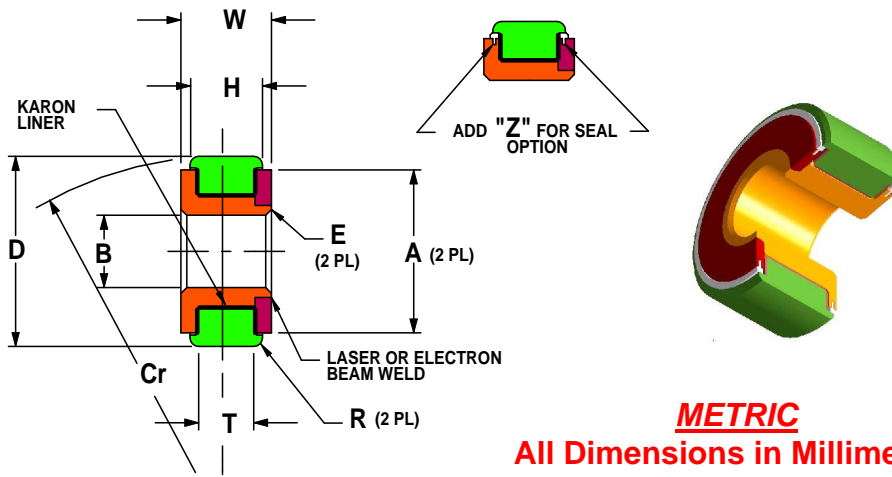

METRIC
All Dimensions in Millimeters

Part Number Example:
KRP 522-06 V I Z D

KRP = KArOn Bearing Prefix
522 = Crowned Track Roller Series
-06 = 9.525 mm Bore Diameter (Diameter in 1/16 inch increments)
V = KArOn V Liner (See Table 1 for liner Options)
T = Add "T" for Track Roller (not optional in P/N)
Z = Add "Z" for Seal Option
D = Add "D" for 440C Outer Race Option

KRP522 SERIES	B	D	W	H	E	A	R	Cr	RADIAL STATIC LIMIT LOAD (KN) See Notes 1 & 2	WEIGHT KG (REF)
BEARING NUMBER	BORE DIA +0.000 -0.018	ROLLER OUTER DIA. +0.000 -0.025	INNER RACE WIDTH +0.000 -0.254	OUTER RACE WIDTH +0.000 -0.381	45 DEG CHAMFER +0.254 -0.000	THRUST RING DIA (REF)	CORNER RADIUS +0.254 -0.000	CROWN RADIUS (REF)		
KRP522-03	4.826	19.050	7.925	7.112	0.559	11.18	0.56	254	21.3	0.01
KRP522-04	6.350	22.225	9.525	8.763	0.559	13.21	0.56	254	34.2	0.03
KRP522-06	9.525	25.464	12.700	11.557	0.559	17.02	0.56	254	57.8	0.05
KRP522-08	12.700	33.338	15.875	14.732	0.813	21.34	0.81	317.5	102.2	0.09
KRP522-10	15.875	38.100	19.050	17.907	0.813	24.13	0.81	444.5	155.6	0.14
KRP522-12	19.050	44.450	25.400	24.130	0.813	28.19	0.81	635	233.3	0.25
KRP522-14	22.225	50.800	28.575	27.305	0.813	30.99	0.81	698.5	296.4	0.39
KRP522-16	25.400	53.975	30.150	31.750	0.813	41.40	0.81	762	366.2	0.59
KRP522-20	31.750	57.150	31.750	36.576	0.813	44.45	0.81	762	462.2	0.80
KRP522-24	38.100	76.225/76.170	38.100	36.576	0.813	50.80	0.81	1524	644.4	1.00
KRP522-28	44.450	87.338/87.282	38.100	36.576	0.813	57.91	0.81	1524	726.7	1.32
KRP522-32	50.800	98.450/98.395	38.100	36.576	0.813	65.02	0.81	1524	806.7	1.64
KRP522-36	57.150	109.563/109.507	38.100	36.576	0.813	72.64	0.81	1524	920.0	2.05
KRP522-40	63.500	120.675/120.620	38.100	36.576	0.813	78.99	0.81	1524	1006.7	2.45
KRP522-44	69.850	127.025/126.970	38.100	36.576	0.813	84.84	0.81	1524	1048.9	2.55

OUTER RACE	INNER RACE	THRUST RING	LINER	DESIGNATION	
AMS 5617 CUSTOM 455 Rc 47 MIN	AMS 5643 (17-4PH) Rc 28 MIN (COND H1150 REFERENCE)	AMS 5643 (17-4PH) Rc 28 MIN (COND H1150 REFERENCE)	KARON (SEE TABLE 1 FOR LINER OPTIONS)	ADD SUFFIX "Z" TO P/N FOR SEAL OPTION (ACETAL RESIN OR NYLON)	ADD SUFFIX "D" TO PART NUMBER FOR 440C OUTER RACE AMS 5630 Rc 55-62

NOTES:

1. Load ratings shown are based on KArOn V liner system.
2. Loads shown are based on bearing components only, bolt/pin shear is not considered.
3. For all Sizes:
Radial Play = 0.038 to 0.089 mm
Axial Play = 0.130 to 0.381 mm

Track Rollers, Cam Followers & Airframe Bearings

KRP 523 Series – Self-Lubricating, Airframe, Pivot & Track Roller Bearings Typical Aircraft High Load Flap Track Roller Series

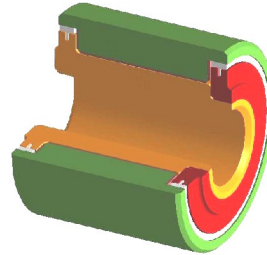
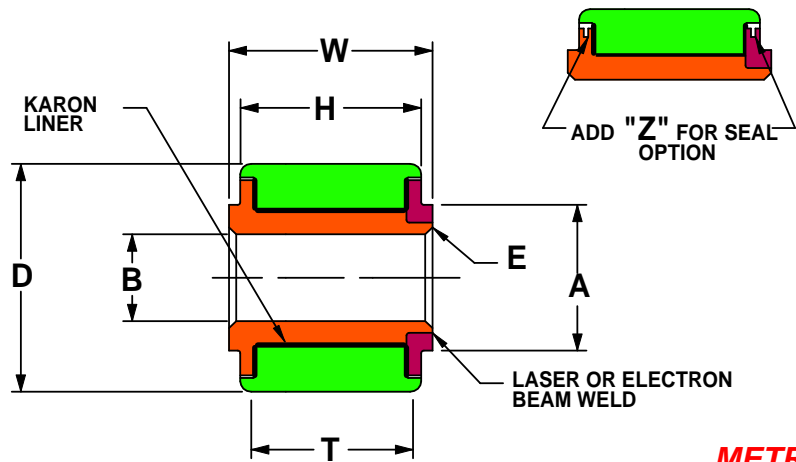

Part Number Example:
KRP 523-06 V I Z D

KRP = KAron Track Roller Bearing Prefix
523 = Non-Studded Roller Series
-06 = 9.525 mm Bore Diameter (Diameter in 1/16 inch increments)
V = KAron V Liner (See Table 1 for liner Options)
T = Track Roller Designation (not optional in p/n)
Z = Add "Z" for Seal Option
D = Add "D" for 440C Outer Race Option

For all Sizes:
 Radial Play = 0.038 to 0.089 mm
 Axial Play = 0.130 to 0.381 mm

METRIC
 All Dimensions in Millimeters

KRP503 SERIES	B	D	W	H	E	A	T	RADIAL STATIC LIMIT LOAD (KN) See Notes 1 & 2	WEIGHT (KG) (REF)
BEARING NUMBER	BORE DIA	ROLLER OUTER DIA.	INNER RACE WIDTH	OUTER RACE WIDTH	RADIUS OR 45 DEG CHAMFER	THRUST RING DIA (REF)	TRACK CONTACT WIDTH MIN		
	+0.000 -0.013	+0.000 -0.025	+0.000 -0.127	+0.000 -0.127	+0.254 -0.000				
KRP523-04	6.350	22.225	19.050	18.034	0.559	13.21	14.73	73.4	0.054
KRP523-06	9.525	28.575	25.400	23.876	0.559	17.02	19.05	129.0	0.113
KRP523-08	12.700	34.925	31.750	30.226	0.813	21.34	25.40	222.4	0.204
KRP523-10	15.875	41.275	38.100	36.576	0.813	24.13	28.70	338.1	0.336
KRP523-12	19.050	47.625	44.450	42.926	0.813	28.19	35.05	435.9	0.517
KRP523-14	22.225	53.975	50.800	49.276	0.813	30.99	41.40	564.9	0.748
KRP523-16	25.400	60.325	57.150	55.626	0.813	40.13	47.75	769.6	1.043
KRP523-20	31.750	69.850	63.500	61.976	0.813	41.40	51.56	992.0	1.497
KRP523-24	38.100	76.225/76.170	69.850	68.326	0.813	50.80	57.91	1258.9	1.859
KRP523-28	44.450	87.338/87.282	76.200	74.676	0.813	57.91	66.80	1556.9	2.630
KRP523-32	50.800	98.450/98.395	76.200	74.676	0.813	65.02	66.80	1726.0	3.311

OUTER RACE	INNER RACE	THRUST RING	LINER	DESIGNATION	
AMS 5617 CUSTOM 455 Rc 47 MIN	AMS 5643 (17-4PH) Rc 28 MIN (COND H1150 REFERENCE)	AMS 5643 (17-4PH) Rc 28 MIN (COND H1150 REFERENCE)	KARON (SEE TABLE 1 FOR LINER OPTIONS)	ADD SUFFIX Z TO P/N FOR SEAL OPTION (ACETAL RESIN OR NYLON)	ADD SUFFIX D TO PART NUMBER FOR 440C OUTER RACE AMS 5630 Rc 55-62

- NOTES:**
- Load ratings shown are based on KAron V liner system.
 - Loads shown are based on bearing components only, bolt/pin shear is not considered.

Track Rollers, Cam Followers & Airframe Bearings

KRP 527 Series – KAron Lined, Self-Aligning, Self-Lubricating, Track Roller/ Cam Follower Series

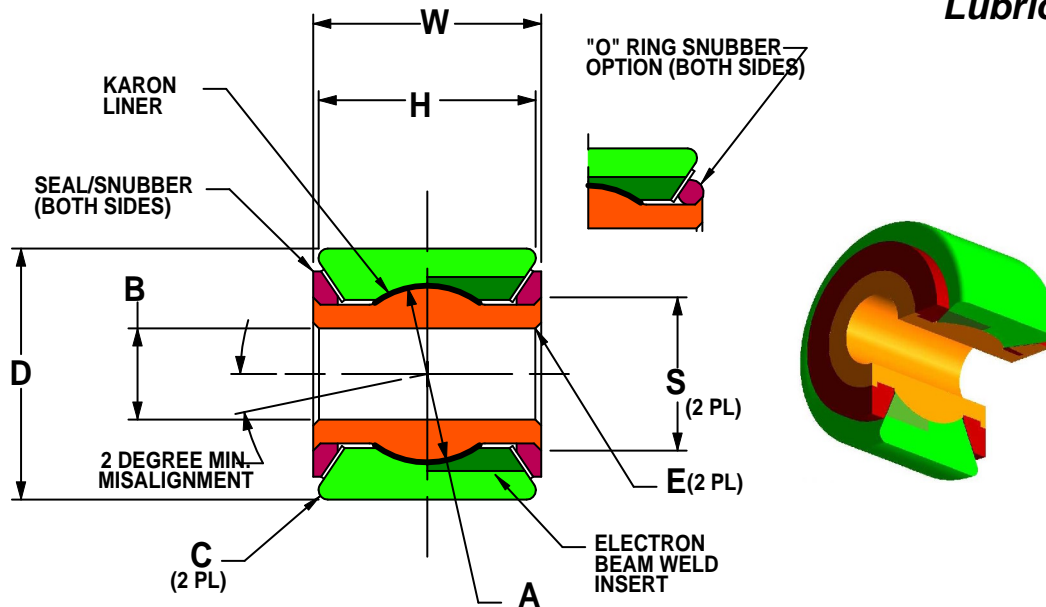

Part Number Example:

KRP 527 08 V I

KRP = KAron Bearing Prefix
527 = Self-Aligning Roller Series
-08 = 12.700 mm Bore Diameter (Diameter in 1/16 inch increments)
V = KAron V Liner (See Table 1 for liner Options)
I = Track Roller Application

For all Sizes:

Radial Play = 0.076 mm maximum

Rotational Torque (no-load) = 0.23 N-m maximum

METRIC

All Dimensions in Millimeters

KRP527 SERIES	B	D	W	H	E	A	C	S	RADIAL STATIC LIMIT LOAD (KN) See Notes 1 & 2	WEIGHT KG (REF)
BEARING NUMBER	BORE DIA +.000 -.018	ROLLER OUTER DIA. +.000 -.025	INNER RACE WIDTH +.000 -.254	OUTER RACE WIDTH +.000 -.254	45 DEG CHAMFER +.254 -.000	INNER RACE SPHERICAL DIA (REF)	CORNER RADIUS (MINIMUM)	CLAMP-UP DIAMETER (REF)		
KRP527-04	6.350	22.225	19.050	16.662	0.56	15.49	0.51	13.21	56.0	0.054
KRP527-06	9.525	28.575	25.400	23.876	0.56	20.32	1.02	17.02	89.4	0.113
KRP527-08	12.700	34.925	31.750	30.226	0.81	24.59	1.27	21.34	122.3	0.204
KRP527-10	15.875	41.275	38.100	36.576	0.81	30.48	1.27	23.11	218.0	0.336
KRP527-12	19.050	47.625	44.450	42.926	0.81	34.93	1.27	28.19	233.1	0.517
KRP527-14	22.225	53.975	50.800	49.276	0.81	41.15	1.27	30.99	317.2	0.748

OUTER RACE & INSERT	INNER RACE	SEAL / SNUBBER	LINER
AMS 5617 CUSTOM 455 Rc 47 MIN	AMS 5643 (17-4PH) Rc 28 MIN (COND H1150 REFERENCE)	PTFE / ELASTOMER	KARON (SEE TABLE 1 FOR LINER OPTIONS)

NOTES:

1. Load ratings shown are based on KAron V liner system.
2. Loads shown are based on bearing components only, bolt/pin shear is not considered.

Track Rollers, Cam Followers & Airframe Bearings

KRP 505 Series – Self-Lubricating Airframe, Pivot & Track Roller Bearings

Dimensionally Equivalent to MS24461 Series

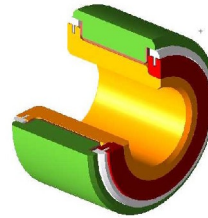
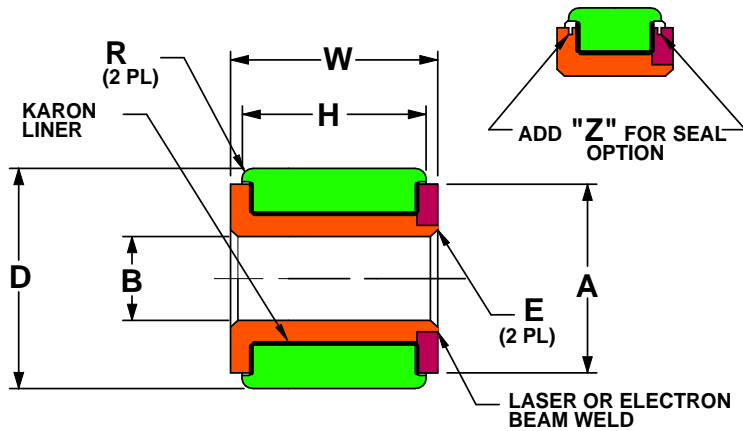

METRIC
All Dimensions in Millimeters

Part Number Example:
KRP 505-06 V I Z D P

KRP = KAron Bearing Prefix
 505 = Airframe/Pivot/Roller Series
 -06 = 9.525 mm ID (Diameter in 1/16 inch increments)
 V = KAron V Liner (See Table 1 for liner Options)
 T = Add "T" for Track Roller (Custom 455 Outer Race) Option
 Z = Add "Z" for Seal Option
 D = Add "D" for 440C Outer Race Option
 = Add "P" for OD Cadmium Plate Option (per QQ-P-416 Type II, Class 2)

KRP505 SERIES	B		D		W	H	E	A	R	RADIAL STATIC LIMIT LOAD (KN) See Notes 1 & 2	AXIAL STATIC LIMIT LOAD (KN)	WEIGHT KG (REF)
BEARING NUMBER	BORE DIA		ROLLER OUTER DIA.		INNER RACE WIDTH	OUTER RACE WIDTH	RADIUS OR 45 DEG CHAMFER TO CLEAR FILLET RAD	THRUST RING DIA (REF)	RADIUS OR 45 DEG CHAMFER			
	+0.000	-0.013	+0.000	-0.013	+0.000	-0.127			+0.25	-0.000		
KRP505-03	4.826		17.463		7.925	5.537	0.559	13.46	0.56	18.0	9.1	0.014
KRP505-04	6.350		19.050		9.525	7.137	0.559	15.49	0.56	29.6	11.1	0.018
KRP505-05	7.938		20.638		11.100	8.738	0.559	16.26	0.56	40.8	13.1	0.023
KRP505-06	9.525		22.225		14.275	11.913	0.559	18.29	0.56	68.7	15.4	0.032
KRP505-07	11.113		23.813		15.875	13.487	0.813	19.81	0.81	88.5	17.4	0.041
KRP505-08	12.700		28.575		19.050	16.662	0.813	24.64	0.81	127.5	20.1	0.077
KRP505-09	14.288	14.270	30.163		22.225	19.837	0.813	26.16	0.81	158.2	22.1	0.100
KRP505-10	15.875	15.857	31.750		25.400	23.012	0.813	27.69	0.81	189.7	24.1	0.122
KRP505-12	19.050	19.032	34.925		28.575	25.400	0.813	30.99	0.81	252.7	28.5	0.154
KRP505-14	22.225	22.207	41.275		31.750	28.575	0.813	37.34	0.81	327.9	32.9	0.240
KRP505-16	25.400	25.382	44.450		31.750	28.575	0.813	39.37	0.81	379.5	37.5	0.263
KRP505-20	31.750	31.732	50.800	50.785	31.750	26.645	0.813	45.72	0.81	455.4	45.9	0.313
KRP505-24	38.100	38.082	57.150	57.135	31.750	26.645	0.813	52.07	0.81	531.3	54.3	0.358
KRP505-28	44.450	44.432	63.500	63.485	31.750	26.645	0.813	58.42	0.81	607.2	62.9	0.408
KRP505-32	50.800	50.782	69.850	69.835	31.750	26.645	0.813	64.77	0.81	683.1	71.1	0.454
KRP505-36	57.150	57.132	76.200	76.185	31.750	26.645	0.813	71.12	0.81	759.0	79.6	0.503
KRP505-40	63.500	63.482	82.550	82.530	31.750	26.645	0.813	77.47	0.81	834.9	87.8	0.553
KRP505-44	69.850	69.832	88.900	88.880	31.750	26.645	0.813	83.82	0.81	910.8	96.2	0.603
KRP505-48	76.200	76.182	95.250	95.230	31.750	26.645	0.813	90.17	0.81	987.2	104.6	0.649
KRP505-52	82.550	82.530	101.600	101.580	31.750	26.645	0.813	96.52	0.81	1062.6	113.3	0.680

OUTER RACE	INNER RACE	THRUST RING	LINER	DESIGNATION		
AMS 5643 (17-4PH) Rc 28 MIN (COND H1150 REFERENCE)	AMS 5643 (17-4PH) Rc 40 MIN (COND H900 REFERENCE)	AMS 5643 (17-4PH) Rc 40 MIN (COND H900 REFERENCE)	KARON (SEE TABLE 1 FOR LINER OPTIONS)	ADD SUFFIX "Z" TO P/N FOR SEAL OPTION (ACETAL RESIN OR NYLON)	ADD SUFFIX "T" FOR TRACK ROLLER OPTION AMS 5617 OUTER RACE CUSTOM 455 Rc 47 MIN	ADD SUFFIX "D" TO PART NUMBER FOR 440C OUTER RACE AMS 5630 Rc 55 -62

NOTES:

- Load ratings shown are based on KAron V liner system.
- Loads shown are based on bearing components only, bolt/pin shear is not considered.
- For all Sizes:
Radial Play = 0.038 to 0.089 mm
Axial Play = 0.127 to 0.381 mm

Track Rollers, Cam Followers & Airframe Bearings

KRP 506 Series –Self-Lubricating, Airframe, Pivot & Track Roller Bearings

Dimensionally Equivalent to MS24462 Series

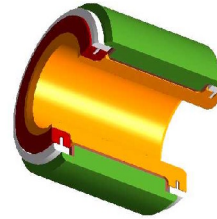
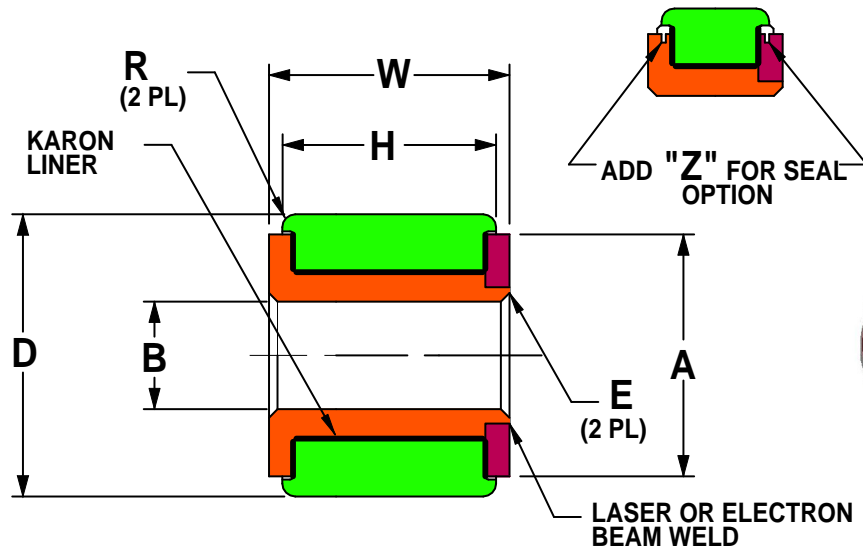

METRIC
All Dimensions in Millimeters

Part Number Example:
KRP 506-06 V I Z D P

KRP = KAron Bearing Prefix
 506 = Airframe/Pivot/Roller Series
 -06 = 9.525 mm ID (Diameter in 1/16 inch increments)
 V = KAron V Liner (See Table 1 for liner Options)
 T = Add "T" for Track Roller (Custom 455 Outer Race) Option
 Z = Add "Z" for Seal Option
 D = Add "D" for 440C Outer Race Option
 P = Add "P" for OD Cadmium Plate Option (per QQ-P-416 Type II, Class 2)

For all Sizes:
 Radial Play = 0.038 to 0.089 mm
 Axial Play = 0.127 to 0.381 mm

KRP506 SERIES	B	D	W	H	E	A	R	RADIAL STATIC LIMIT LOAD (KN) See Notes 1 & 2	AXIAL STATIC LIMIT LOAD (KN)	WEIGHT KG (REF)
KRP506-03	4.826	15.875	15.875	12.700	0.559	12.95	0.56	51.6	9.1	0.023
KRP506-04	6.350	15.875	14.275	12.700	0.559	12.95	0.56	47.1	10.4	0.018
KRP506-05	7.938	17.463	15.875	12.700	0.559	14.48	0.56	63.4	12.4	0.027
KRP506-06	9.525	19.050	20.625	19.050	0.559	16.00	0.56	99.8	14.7	0.036
KRP506-07	11.113	20.638	22.225	19.050	0.559	17.53	0.56	116.6	16.4	0.041
KRP506-08	12.700	25.400	22.225	19.050	0.813	22.35	0.81	137.4	19.4	0.063
KRP506-10	15.875	28.575	22.225	19.050	0.813	25.40	0.81	164.5	23.8	0.073
KRP506-12	19.050	31.750	28.575	25.400	0.813	28.45	0.81	216.5	27.8	0.113
KRP506-14	22.225	34.925	28.575	25.400	0.813	31.75	0.81	252.6	32.2	0.127
KRP506-16	25.400	38.100	28.575	25.400	0.813	35.05	0.81	323.7	36.2	0.141
KRP506-20	31.750	47.625	34.925	31.750	0.813	44.45	0.81	497.4	44.6	0.277

OUTER RACE	INNER RACE	THRUST RING	LINER	DESIGNATION		
AMS 5643 (17-4PH) Rc 28 MIN (COND H1150 REFERENCE)	AMS 5643 (17-4PH) Rc 40 MIN (COND H900 REFERENCE)	AMS 5643 (17-4PH) Rc 40 MIN (COND H900 REFERENCE)	KARON (SEE TABLE 1 FOR LINER OPTIONS)	ADD SUFFIX "Z" TO P/N FOR SEAL OPTION (ACETAL RESIN OR NYLON)	ADD SUFFIX "T" FOR TRACK ROLLER OPTION AMS 5617 OUTER RACE CUSTOM 455 Rc 47 MIN	ADD SUFFIX "D" TO PART NUMBER FOR 440C OUTER RACE AMS 5630 Rc 55-62

NOTES:

1. Load ratings shown are based on KAron V liner system.
2. Loads shown are based on bearing components only, bolt/pin shear is not considered.

Rev D May 5, 2004 : KRP506-()VT OPTION WAS 440C
 Rev G Dec 23, 2008: MS24462 was MS24461

Track Rollers, Cam Followers & Airframe Bearings

KRP () Series – Self-Lubricating Airframe/Pivot Bearings

Dimensionally Equivalent to MS27640 Series

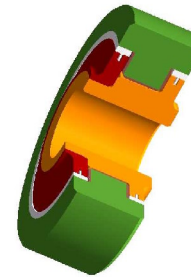
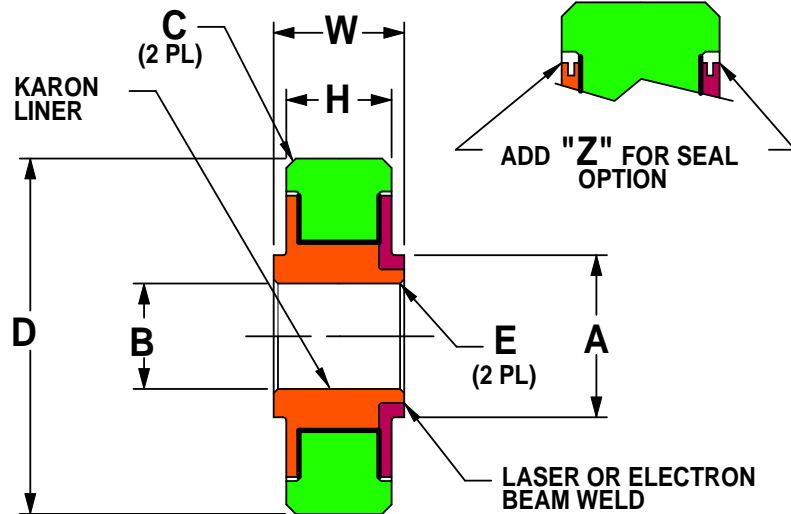

Part Number Example:

KRP 06 V Z P

KRP = KAron Bearing Prefix

-06 = 9.525 mm ID (Diameter in 1/16 inches increments)

V = KAron V Liner (See Table 1 for liner Options)

Z = Add "Z" for Seal Option

P = Add "P" for OD Cadmium Plate Option (per QQ-P-416 Type II, Class 2)

For all Sizes:

Radial Play = 0.038 to 0.089 mm

Axial Play = 0.127 to 0.381 mm

METRIC

All Dimensions in Millimeters

KRP () SERIES	B	D	W	H	E	A	C	RADIAL STATIC LIMIT LOAD (KN) See Notes 1 & 2	AXIAL STATIC LIMIT LOAD (KN)	WEIGHT KG (REF)
BEARING NUMBER	BORE DIA +0.000 -0.013	ROLLER OUTER DIA. +0.000 -0.013	INNER RACE WIDTH +0.000 -0.127	OUTER RACE WIDTH +0.000 -0.127	45 DEG CHAMFER +0.38 -0.00	THRUST RING DIA (REF)	45 DEG CHAMFER +0.38 -0.00			
KRP03	4.826	19.746	7.544	6.858	0.13	8.89	0.56	15.2	9.1	0.018
KRP04	6.350	22.896	12.294	8.509	0.13	10.41	0.81	26.1	11.1	0.032
KRP05	7.938	31.750	14.173	9.525	0.38	11.94	0.81	34.0	13.1	0.063
KRP06	9.525	36.513	15.748	11.913	0.38	14.99	0.81	59.7	16.8	0.104
KRP08	12.700	42.863	15.748	12.700	0.38	19.56	1.12	78.6	23.1	0.141
KRP10	15.875	49.213	15.748	12.700	0.38	21.59	1.12	98.3	27.6	0.172

OUTER RACE	INNER RACE	THRUST RING	LINER	DESIGNATION
AMS 5643 (17-4PH) Rc 28 MIN (COND H1150 REFERENCE)	AMS 5643 (17-4PH) Rc 40 MIN (COND H900 REFERENCE)	AMS 5643 (17-4PH) Rc 40 MIN (COND H900 REFERENCE)	KARON (SEE TABLE 1 FOR LINER OPTIONS)	ADD SUFFIX "Z" TO P/N FOR SEAL OPTION (ACETAL RESIN OR NYLON)

NOTES:

1. Load ratings shown are based on KAron V liner system.
2. Loads shown are based on bearing components only, bolt/pin shear is not considered.

Track Rollers, Cam Followers & Airframe Bearings

KRP ()A Series – Self-Lubricating, Narrow Airframe/Pivot Bearings

Dimensionally Equivalent to MS27641 Series

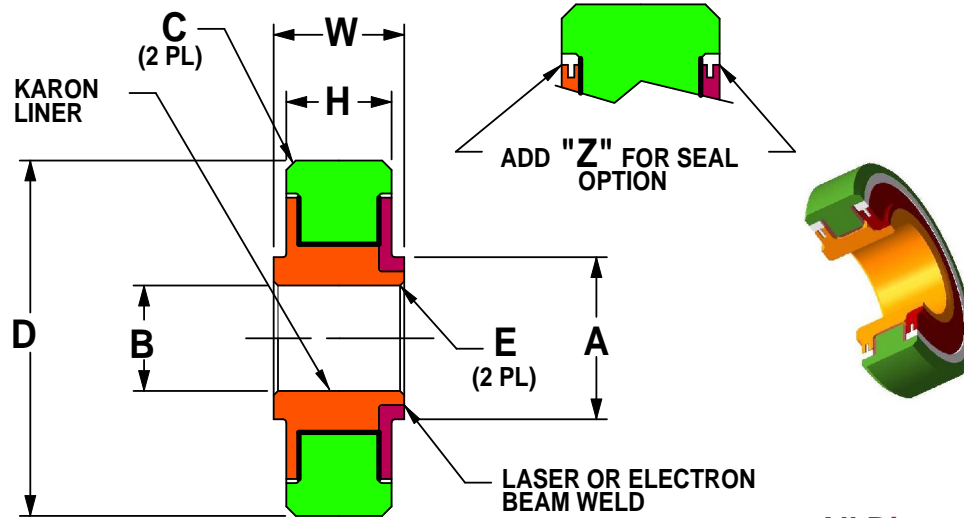

Part Number Example:
KRP 06 A V Z P

KRP = KAron Bearing Prefix
 -06 = 9.525 mm ID (Diameter in 1/16 inch increments)
 A = Narrow Airframe/Pivot Bearing
 V = KAron V Liner (See Table 1 for liner Options)
 Z = Add "Z" for Seal Option
 P = Add "P" for OD Cadmium Plate Option (per QQ-P-416 Type II, Class 2)

For all Sizes:
 Radial Play = 0.038 to 0.089 mm
 Axial Play = 0.127 to 0.381 mm

METRIC
 All Dimensions in Millimeters

KRP() A SERIES	B	D	W	H	E	A	C	RADIAL STATIC LIMIT LOAD (KN) See Notes 1 & 2	AXIAL STATIC LIMIT LOAD (KN)	WEIGHT KG (REF)
BEARING NUMBER	BORE DIA +0.000 -0.013	ROLLER OUTER DIA. +0.000 -0.013	INNER RACE WIDTH +0.000 -0.127	OUTER RACE WIDTH +0.000 -0.127	45 DEG CHAMFER +0.38 -0.00	THRUST RING DIA (REF)	45 DEG CHAMFER +0.38 -0.00			
KRP03A	4.826	15.875	7.544	5.944	0.13	8.890	0.41	10.1	9.1	0.009
KRP04A	6.350	19.050	7.137	5.563	0.13	10.414	0.41	10.7	10.2	0.014
KRP05A	7.938	20.638	7.544	5.944	0.38	11.938	0.41	13.6	13.1	0.014
KRP06A	9.525	22.225	7.950	6.350	0.38	13.716	0.41	18.7	15.4	0.018
KRP08A	12.700	28.575	9.525	7.950	0.38	16.764	0.41	34.3	19.4	0.036
KRP10A	15.875	34.925	10.312	8.738	0.38	20.066	0.81	50.3	23.8	0.054
KRP12A	19.050	41.275	11.100	9.525	0.38	23.368	0.81	66.5	27.8	0.086
KRP16A	25.400	50.800	12.700	11.125	0.38	31.496	0.81	111.2	37.5	0.141
KRP20A	31.750	57.150	12.700	11.125	0.38	37.592	0.81	132.7	45.9	0.163

OUTER RACE	INNER RACE	THRUST RING	LINER	DESIGNATION
AMS 5643 (17-4PH) Rc 28 MIN (COND H1150 REFERENCE)	AMS 5643 (17-4PH) Rc 40 MIN (COND H900 REFERENCE)	AMS 5643 (17-4PH) Rc 40 MIN (COND H900 REFERENCE)	KARON (SEE TABLE 1 FOR LINER OPTIONS)	ADD SUFFIX "Z" TO P/N FOR SEAL OPTION (ACETAL RESIN OR NYLON)

- NOTES:**
- Load ratings shown are based on KAron V liner system.
 - Loads shown are based on bearing components only, bolt/pin shear is not considered.

Track Rollers, Cam Followers & Airframe Bearings

KRP ()B Series – Self-Lubricating, Narrow Airframe/Pivot Bearings Dimensionally Equivalent to MS27642 Series

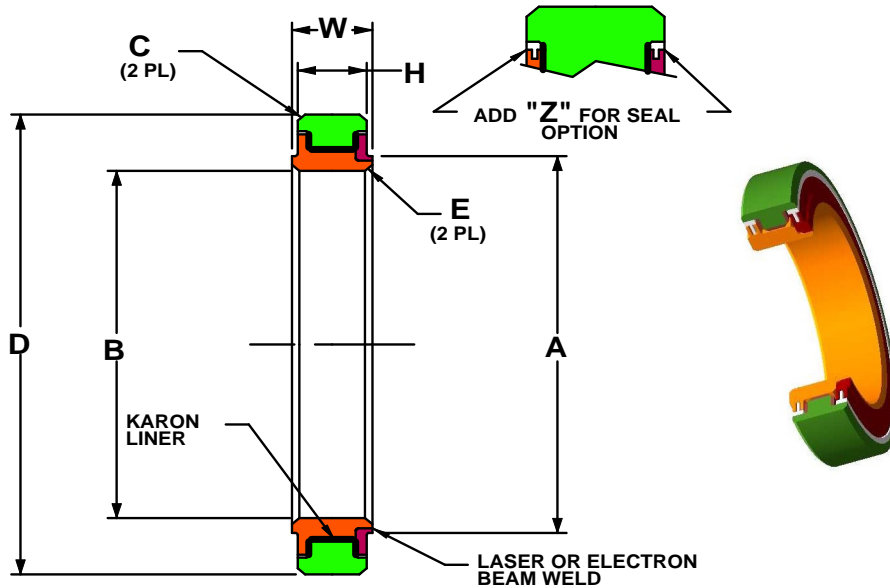

Part Number Example:
KRP 16 B V Z P

KRP = KAron Bearing Prefix
16 = 25.400 mm ID (Diameter in 1/16 inch increments)
B = Airframe/Pivot Bearing
V = KAron V Liner (See Table 1 for liner Options)
Z = Add "Z" for Seal Option
P = Add "P" for OD Cadmium Plate Option (per QQ-P-416 Type II, Class 2)

For all Sizes:
 Radial Play = 0.038 to 0.089 mm
 Axial Play = 0.127 to 0.381 mm

METRIC
 All Dimensions in Millimeters

KRP() B SERIES	B	D	W	H	E	A	C	RADIAL STATIC LIMIT LOAD (KN) See Notes 1 & 2	AXIAL STATIC LIMIT LOAD (KN)	WEIGHT KG (REF)
BEARING NUMBER	BORE DIA +.000 -.025	ROLLER OUTER DIA. +.000 -.025	INNER RACE WIDTH +.000 -.127	OUTER RACE WIDTH +.000 -.127	45 DEG CHAMFER +.38 -.00	THRUST RING DIA (REF)	45 DEG CHAMFER +.38 -.00			
KRP16B	25.400	44.450	11.100	9.525	0.61	30.480	0.61	86.7	36.9	0.082
KRP21B	33.350	52.388	11.100	9.525	0.61	38.354	0.61	109.2	47.3	0.104
KRP23B	36.525	55.563	11.100	9.525	0.61	41.656	0.61	118.5	51.6	0.109
KRP25B	39.700	58.738	11.100	9.525	0.61	44.704	0.61	127.2	55.6	0.118
KRP29B	46.050	65.088	11.100	9.525	0.61	51.054	0.61	145.3	64.0	0.132
KRP33B	52.400	71.438	11.100	9.525	0.61	57.404	0.61	163.4	72.4	0.150
KRP37B	58.750	77.788	11.100	9.525	0.61	63.754	0.61	181.5	80.8	0.163
KRP47B	74.625	98.425	13.487	11.913	0.99	79.756	0.99	245.2	101.9	0.331
KRP49B	77.800	101.600	13.487	11.913	0.99	82.804	0.99	254.5	105.9	0.340

OUTER RACE	INNER RACE	THRUST RING	LINER	DESIGNATION
AMS 5643 (17-4PH) Rc 28 MIN (COND H1150 REFERENCE)	AMS 5643 (17-4PH) Rc 40 MIN (COND H900 REFERENCE)	AMS 5643 (17-4PH) Rc 40 MIN (COND H900 REFERENCE)	KARON (SEE TABLE 1 FOR LINER OPTIONS)	ADD SUFFIX "Z" TO P/N FOR SEAL OPTION (ACETAL RESIN OR NYLON)

- NOTES:**
- Load ratings shown are based on KAron V liner system.
 - Loads shown are based on bearing components only, bolt/pin shear is not considered.

Track Rollers, Cam Followers & Airframe Bearings

KRP()BS Series – Self-Lubricating, Torque Tube, Airframe, Pivot Bearings Dimensionally Equivalent to MS27648 Series

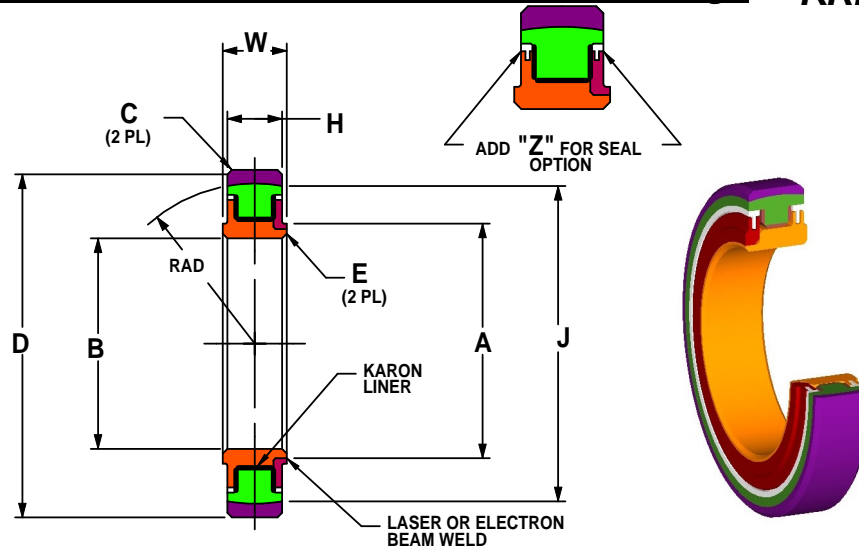

Part Number Example:

KRP 23 BS V Z P

KRP = KAron Bearing Prefix

23 = 1.4380 Bore Diameter (Diameter in 1/16 increments)

BS = Self-aligning Torque Tube Bearing

V = KAron V Liner (See Table 1 for liner Options)

Z = Add "Z" for Seal Option

P = Add "P" for OD Cadmium Plate Option (per QQ-P-416 Type II, Class 2)

For all Sizes:

Radial Play = 0.038 to 0.089 mm

Axial Play = 0.127 to 0.381 mm

METRIC
All Dimensions in Millimeters

KRP()BS SERIES	B	D	W	H	E	A	C	J	RADIAL STATIC LIMIT LOAD (KN) See Notes 1 & 2	AXIAL STATIC LIMIT LOAD (KN)	WEIGHT (KG)
BEARING NUMBER	BORE DIA +0.000 -0.025	ROLLER OUTER DIA. +0.000 -0.025	INNER RACE WIDTH +0.000 -0.127	OUTER RACE WIDTH +0.000 -0.127	45 DEG CHAMFER +0.38 -0.00	THRUST RING DIA (REF)	45 DEG CHAMFER +0.38 -0.00	TO SHARP CORNER (REF)			
KRP16BS	25.400	49.213	11.100	9.525	0.61	30.480	0.61	43.43	86.7	36.9	0.100
KRP21BS	33.350	57.150	11.100	9.525	0.61	38.354	0.61	51.56	109.2	47.3	0.122
KRP23BS	36.525	60.325	11.100	9.525	0.61	41.656	0.61	54.74	118.5	51.6	0.132
KRP25BS	39.700	63.500	11.100	9.525	0.61	44.704	0.61	57.96	127.2	55.6	0.145
KRP29BS	46.050	69.850	11.100	9.525	0.61	51.054	0.61	64.39	145.3	64.0	0.159
KRP33BS	52.400	76.200	11.100	9.525	0.61	57.404	0.61	70.87	163.4	72.4	0.181
KRP37BS	58.750	82.550	11.100	9.525	0.61	63.754	0.61	77.22	182.3	80.8	0.195
KRP47BS	74.625	104.775	13.487	11.913	0.99	79.756	0.99	97.66	245.2	101.9	0.399
KRP48BS	76.200	107.950	13.487	11.913	0.99	82.804	0.99	100.84	254.5	105.9	0.413
KRP49BS	77.800	107.950	13.487	11.913	0.99	84.328	0.99	100.84	254.5	105.9	0.413

OUTER RACE	INNER RACE	OUTER RACE SELF-ALIGNING RING	THRUST RING	LINER	DESIGNATION
AMS 5643 (17-4PH) Rc 40 MIN (COND H900 REFERENCE)	AMS 5643 (17-4PH) Rc 40 MIN (COND H900 REFERENCE)	AMS 5643 (17-4PH) Rc 28 MIN (COND H1150 REFERENCE)	AMS 5643 (17-4PH) Rc 40 MIN (COND H900 REFERENCE)	KARON (SEE TABLE 1 FOR LINER OPTIONS)	ADD SUFFIX "Z" TO P/N FOR SEAL OPTION (ACETAL RESIN OR NYLON)

NOTES:

1. Load ratings shown are based on KAron V liner system.
2. Loads shown are based on bearing components only, bolt/pin shear is not considered.

Track Rollers, Cam Followers & Airframe Bearings

KRP ()P Series – KArOn Lined, Self-Lubricating, Wide Airframe/Pivot Bearings Dimensionally Equivalent to MS27644 Series

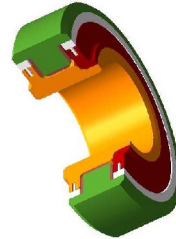
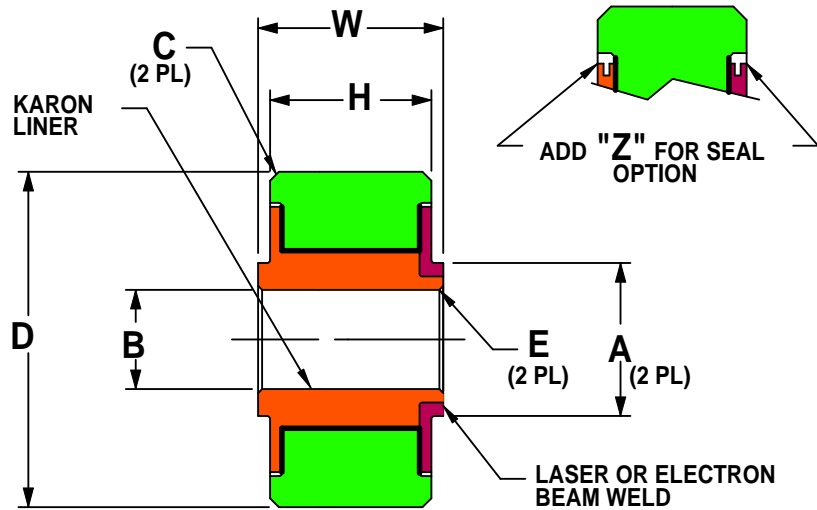

Part Number Example:
KRP 06 P V Z P

KRP = KArOn Bearing Prefix
-06 = 9.525 mm ID (Diameter in 1/16 inch increments)
P = Wide Airframe/Pivot Bearing
V = KArOn V Liner (See Table 1 for liner Options)
Z = Add "Z" for Seal Option
P = Add "P" for OD Cadmium Plate Option (per QQ-P-416 Type II, Class 2)

For all Sizes:
 Radial Play = 0.038 to 0.089 mm
 Axial Play = 0.127 to 0.381 mm

METRIC All Dimensions in Millimeters

KRP () P SERIES	B	D	W	H	E	A	C	RADIAL STATIC LIMIT LOAD (KN) See Notes 1 & 2	AXIAL STATIC LIMIT LOAD (KN)	WEIGHT KG (REF)
BEARING NUMBER	BORE DIA +0.000 -0.013	ROLLER OUTER DIA. +0.000 -0.013	INNER RACE WIDTH +0.000 -0.127	OUTER RACE WIDTH +0.000 -0.127	45 DEG CHAMFER +0.38 -0.00	THRUST RING DIA (REF)	45 DEG CHAMFER +0.38 -0.00			
KRP03P	4.826	19.746	12.573	12.014	0.13	8.890	0.46	30.4	9.0	0.027
KRP04P	6.350	22.896	15.748	12.471	0.13	10.414	0.81	41.5	11.1	0.041
KRP05P	7.938	31.750	18.923	17.450	0.38	12.700	0.81	72.9	14.4	0.109
KRP06P	9.525	36.513	22.098	20.168	0.38	15.875	0.81	119.2	16.8	0.159
KRP08P	12.700	42.863	23.673	21.742	0.38	18.669	1.12	187.9	20.8	0.249
KRP10P	15.875	49.213	25.273	23.368	0.38	22.606	1.12	260.2	25.1	0.340

OUTER RACE	INNER RACE	THRUST RING	LINER	DESIGNATION
AMS 5643 (17-4PH) Rc 28 MIN (COND H1150 REFERENCE)	AMS 5643 (17-4PH) Rc 40 MIN (COND H900 REFERENCE)	AMS 5643 (17-4PH) Rc 40 MIN (COND H900 REFERENCE)	KARON (SEE TABLE 1 FOR LINER OPTIONS)	ADD SUFFIX "Z" TO P/N FOR SEAL OPTION (ACETAL RESIN OR NYLON)

NOTES:

1. Load ratings shown are based on KArOn V liner system.
2. Loads shown are based on bearing components only, bolt/pin shear is not considered.

Track Rollers, Cam Followers & Airframe Bearings

KRPB500 Series – Self-Lubricating, Narrow Airframe, Pivot Bearings Dimensionally Equivalent to MS27646 Series

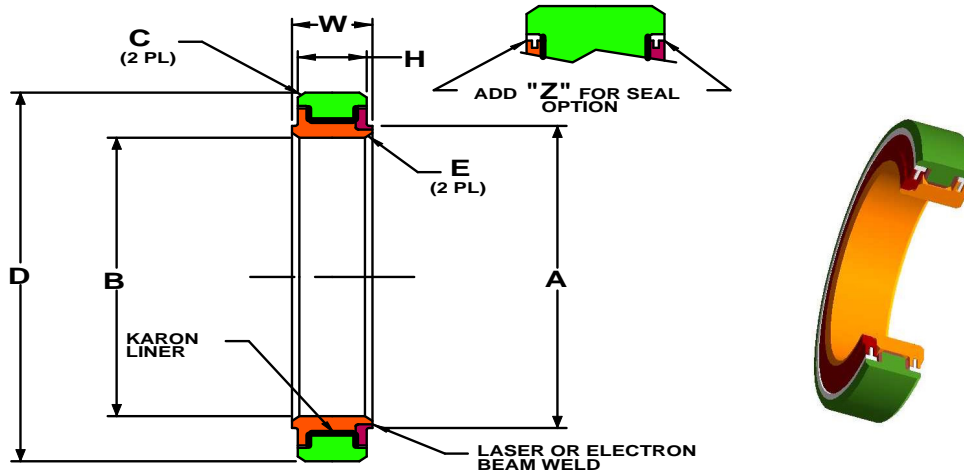

Part Number Example:
KRPB 540 V Z P

KRPB = KAron Bearing Prefix
540 = 22.225 mm ID (Diameter in 1/16 inch increments)
V = KAron V Liner (See Table 1 for liner Options)
Z = Add "Z" for Seal Option
P = Add "P" for OD Cadmium Plate Option (per QQ-P-416 Type II, Class 2)

For all Sizes:
 Radial Play = 0.038 to 0.089 mm
 Axial Play = 0.127 to 0.381 mm

METRIC All Dimensions in Millimeters

KRPB500 SERIES	B	D	W	H	E	A	C	RADIAL STATIC LIMIT LOAD (KN) See Notes 1 & 2	AXIAL STATIC LIMIT LOAD (KN)	WEIGHT KG (REF)
BEARING NUMBER	BORE DIA +.018 -.018	ROLLER OUTER DIA. +.000 -.025	INNER RACE WIDTH +.000 -.127	OUTER RACE WIDTH +.000 -.127	45 DEG CHAMFER +.51 -.00	THRUST RING DIA (REF)	45 DEG CHAMFER +.51 -.00			
KRPB538	15.875	26.988	7.137	6.350	0.38	20.320	0.38	27.8	23.5	0.018
KRPB539	19.050	30.163	7.137	6.350	0.38	23.114	0.38	31.2	26.8	0.023
KRPB540	22.225	33.338	7.137	6.350	0.38	26.416	0.38	36.1	32.2	0.027
KRPB541	26.988	38.100	7.137	6.350	0.38	30.988	0.38	42.3	38.2	0.032
KRPB542	33.338	44.450	7.137	6.350	0.38	37.338	0.38	51.0	46.6	0.036
KRPB543	39.688	50.800	7.137	6.350	0.38	43.688	0.38	59.7	55.0	0.041
KRPB544	46.063/46.012	57.150/57.112	7.137	6.350	0.38	50.038	0.38	68.3	63.3	0.045
KRPB545	52.413/52.362	66.675/66.637	7.137	6.350	0.38	57.912	0.38	79.8	73.1	0.073
KRPB546	58.763/58.712	73.025/72.987	7.137	6.350	0.38	64.770	0.38	27.8	23.5	0.077

OUTER RACE	INNER RACE	THRUST RING	LINER	DESIGNATION
AMS 5643 (17-4PH) Rc 28 MIN (COND H1150 REFERENCE)	AMS 5643 (17-4PH) Rc 40 MIN (COND H900 REFERENCE)	AMS 5643 (17-4PH) Rc 40 MIN (COND H900 REFERENCE)	KARON (SEE TABLE 1 FOR LINER OPTIONS)	ADD SUFFIX "Z" TO P/N FOR SEAL OPTION (ACETAL RESIN OR NYLON)

NOTES:

- Load ratings shown are based on KAron V liner system See Table 1 for liner Options
- Loads shown are based on bearing components only, bolt/pin shear is not considered.