

# IS-199 CHEMICAL MIXER



WHITE  
MOUNTAIN  
IMAGING

# EXPLODED VIEW OF MIXER

## FEATURES

### Specific Gravity Mixing System

The Ultimate in Convenience and Accuracy



### Rugged Field Tested Components

Assure Reliability



### Low Level Warning Systems

Audible and Visible



### Easy-to-Service Design



### UL/CSA Listed Power Supply

External Wall Mount  
Class 2 Transformer



### 24 Volt Operation

Low Voltage from Transformer  
for Safety



### One Year Warranty on all Parts

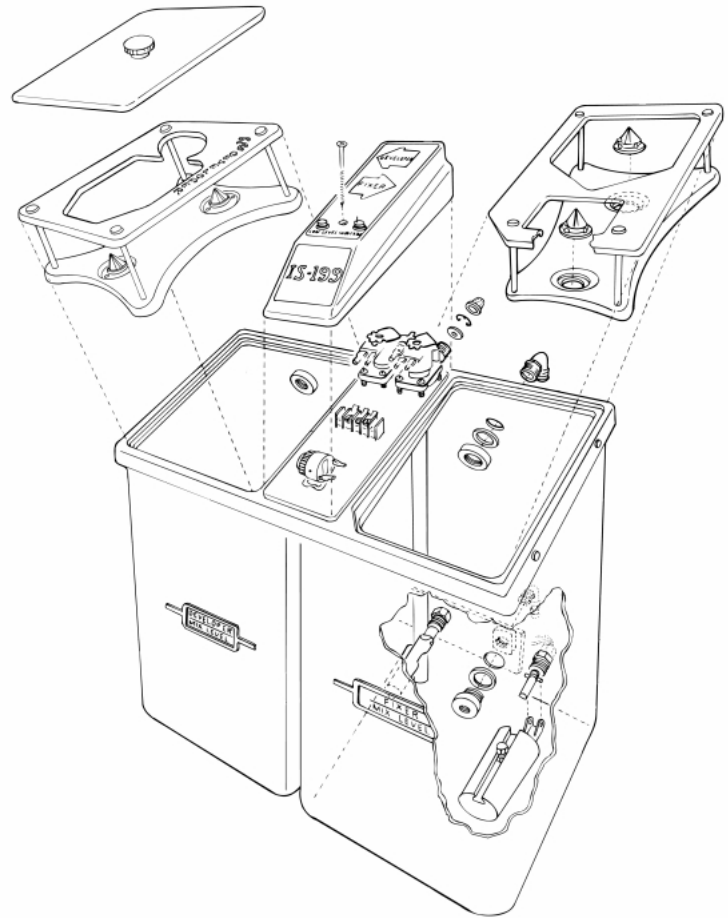

The Versatile Chemical Mixer Mixes the Following Chemicals:

■ Medical X-Ray

■ Industrial X-Ray

■ Graphic Arts

■ Microfilm

The **IS-199** incorporates a unique combination of features which make it the "Mixer of Choice" for both the user and the serviceperson.

The Specific Gravity Mixing System allows the user to start a mix at anytime. The mixer responds to the addition of concentrated chemicals and adds the correct amount of water automatically.

All Electronic Components have been chosen for dependability. Straight-forward circuit designs eliminate the need for circuit boards thereby increasing reliability.

The Low Level Warning System indicates that solution level is 2.0 gallons or less. The warning system resets automatically when the user begins a 5 or 10 gallon mix.

# INSTALLATION SITE SPECIFICATIONS

# TECHNICAL SPECIFICATIONS

## Electrical:

120 VAC, 1/2A, 50/60Hz  
(240 VAC 1/4 A, 50/60Hz is optional)

## Water

18-125 psi, 3GPM or more

## Dimensions, Standard Model

30" H x 24"W x 12"D

## Dimensions, Space Save

21" H x 24"W x 12"D

## Capacity, Standard Model

12.5 Gallons, Dev. & Fixer

## Capacity, Space Save

7.5 Gallons, Dev. & Fixer

## OTHER INFORMATION

All mixers made to order, allow up to 2 weeks for delivery. Mixers also available in 240 volt internal transformers. Rebuilt mixers available upon request. For more information contact White Mountain Imaging.

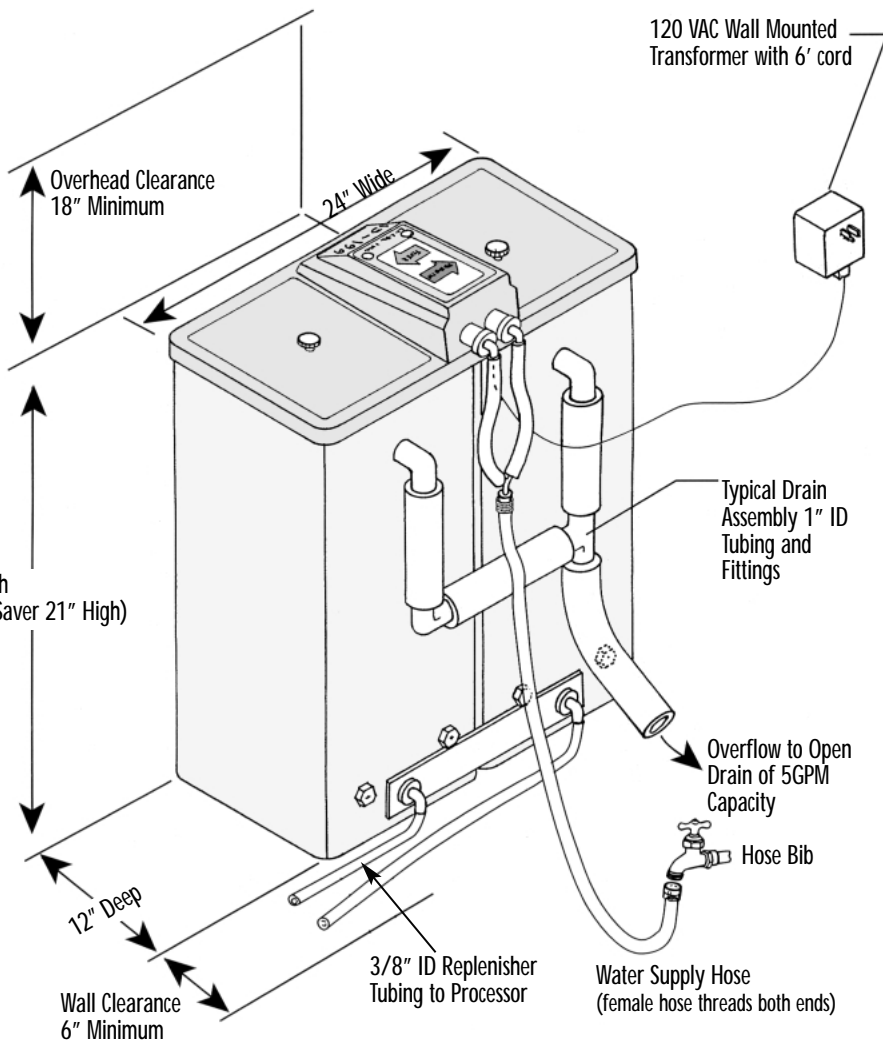

Installer to supply:

- 3/8" Replenisher Tubing
- 1" ID Drain Tubing & Fittings
- High Pressure Water Supply Hose (FGHT Fittings)



## ACCESSORIES

Templates for other bottle configurations are available by request on a custom order basis.

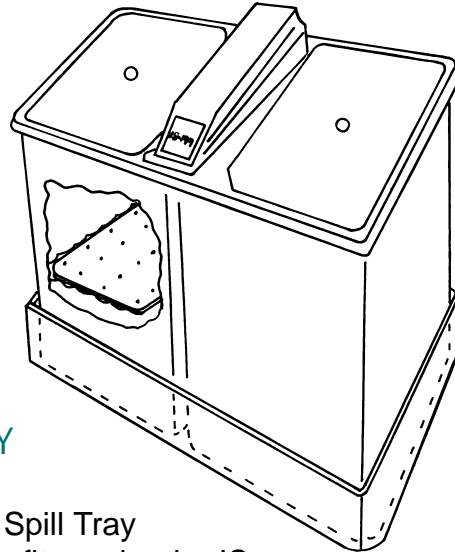

### SPILL TRAY

The IS-199 Spill Tray conveniently fits under the IS-199 Chemical Mixer to provide Secondary Containment for potential leaks or spills

### FLOATING LID

The IS-199 Floating Lid is designed to extend developer life by reducing aerial oxidation. The IS-199 Floating Lid is especially useful in low volume situations where premature oxidation may occur

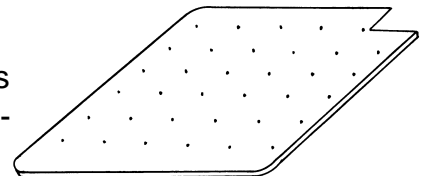

### MIXER TEMPLATES

T2 Developer/T2 Fixer  
WMI Cine Developer/Fixer  
Kodak Developers/Fixers  
Repackaged Developers

AGFA Developers/Fixers  
Cronex Developer/Fixer  
Autex Developer/Fixer  
Simon Developer/Fixer



WHITE  
MOUNTAIN  
IMAGING

PO BOX 216  
SALISBURY, NH 03268  
603 648-2124  
FAX 603 648-2197