

Seal data sheet

Piston seals

K22-R



2008-09

Seal housing

Type 1

Type 2

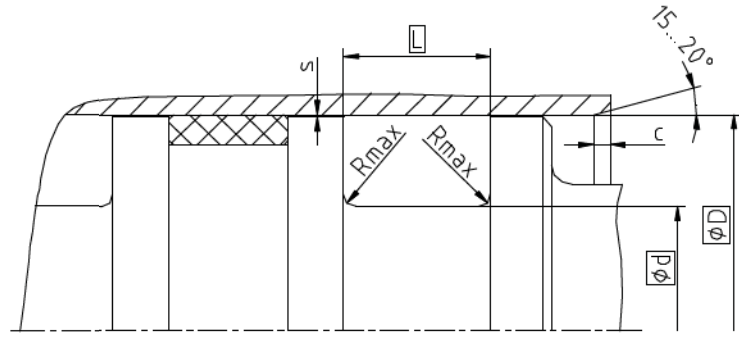
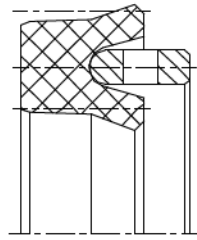
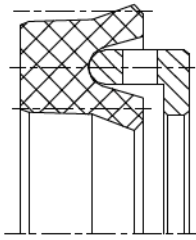

| Surface roughness | Rtmax | Ra |
|-------------------|----------|--------------|
| Sliding Surface | ≤ 2,5 µm | 0,1...0,5 µm |
| Bottom of groove | ≤ 6,3 µm | ≤ 1,6 µm |
| Groove face | ≤ 15 µm | ≤ 3 µm |

Ordering dimensions...□

Bearing area: 50...95% and a cutting depth of 0,5xRz based on Cref = 0%

Standard dimensions

| ØD H9 | Ød h10 | L +0,2 | Rmax | c | max. radial extrusion gap s* | | |
|-----------------|--------|--------|------|------|------------------------------|---------|---------|
| | | | | | 20 bar | 100 bar | 160 bar |
| ≥ 14 ... ≤ 25 | D - 8 | 6,0 | 0,4 | 3,5 | 0,23 | 0,16 | 0,14 |
| > 25 ... ≤ 50 | D - 10 | 7,0 | 0,4 | 4,0 | 0,26 | 0,19 | 0,17 |
| > 50 ... ≤ 75 | D - 12 | 8,0 | 0,4 | 4,5 | 0,29 | 0,22 | 0,20 |
| > 75 ... ≤ 150 | D - 15 | 10,0 | 0,4 | 5,0 | 0,31 | 0,24 | 0,22 |
| > 150 ... ≤ 300 | D - 20 | 12,0 | 0,4 | 6,0 | 0,34 | 0,27 | 0,25 |
| > 300 ... ≤ 500 | D - 25 | 18,0 | 0,4 | 8,5 | 0,37 | 0,30 | 0,29 |
| > 500 ... ≤ 600 | D - 30 | 20,0 | 0,4 | 10,0 | 0,40 | 0,34 | 0,32 |

* Extrusion gap applies to a temperature of 70 °C, higher temperatures require lower values.
Standard: Type 2

Operating parameters

| Sealing material | Support ring | Temperature | max. speed | max. pressure ¹ |
|------------------------|--|-------------------------|----------------|----------------------------|
| SKF ECORUBBER-1 | SKF ECOTAL SKF ECOMID ² | -30 °C...+100 °C | 0,5 m/s | 160 bar (16 Mpa) |
| SKF ECORUBBER-2 | SKF ECOFLON 2 | -20 °C...+100 °C | | |
| SKF ECORUBBER-3 | SKF ECOTAL SKF ECOMID ² | -40 °C...+100 °C | | |
| | SKF ECOFLON 2 | -50 °C...+150 °C | | |
| SKF ECORUBBER-H | SKF ECOTAL SKF ECOMID ² | -25 °C...+100 °C | | |
| | SKF ECOFLON 2 | -25 °C...+150 °C | | |
| SKF ECOFLAS | | -10 °C...+200 °C | | |

The stated operation conditions represent general indications. It is recommended not to use all maximum values simultaneously. Surface speed limits apply only to the presence of adequate lubrication film.

¹ Pressure ratings depend on the size of the extrusion gap.

² ≤ Ø260mm: SKF ECOTAL ; > Ø260mm: SKF ECOMID

Ordering example

K22-P, D=100mm, d=85mm, L=10mm, SKF ECORUBBER-1 / SKF ECOTAL

Piston Seal K22-P
Profile

100 x 85 x 10
D x d x L

SKF ECORUBBER-1 / SKF ECOTAL
Sealing material / Support ring

ECONOMOS

The contents of this data sheet remain the property of SKF Economos GmbH. Duplication, whole or in parts, only upon prior approval. SKF Economos GmbH is unable to guarantee and/or take any responsibility, obligation or liability whatsoever in connection with this information.