

## Piston seals

## Seal housing

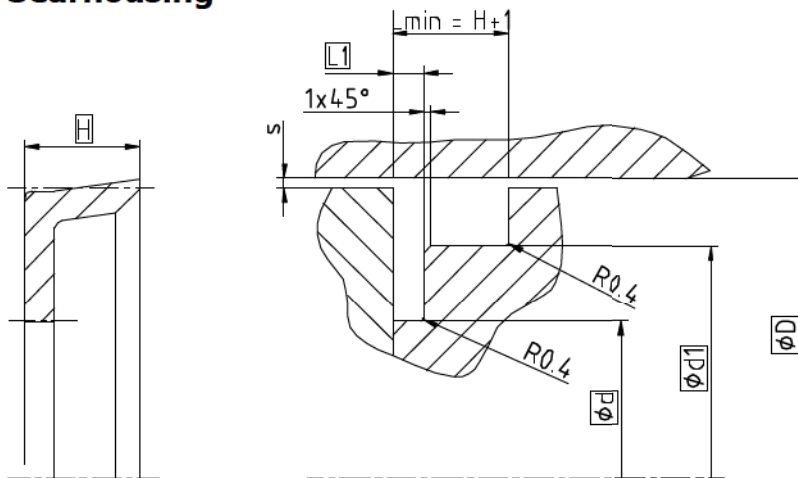

Surface roughness	Rtmax	Ra
Sliding Surface	≤ 2,5 μm	0,1...0,5 μm
Bottom of groove	≤ 6,3 μm	≤ 1,6 μm
Groove face	≤ 15 μm	≤ 3 μm

Ordering dimensions...□

Bearing area: 50...95% and a cutting depth of 0,5xRz based on Cref = 0%

## Standard dimensions

This is not a standard profile and serves as a replacement for an existing housing. New constructions should use standard profiles.

## Operating parameters

Sealing material	Temperature	max. speed		max. pressure	
		linear	rotary	linear <sup>1</sup>	rotary
<b>ECOPUR®</b>	-30 °C...+110 °C	<b>0,5 m/s</b>	<b>2 m/s</b>	<b>160 bar (16 MPa)</b>	<b>7 bar (0,7 MPa)</b>
H-ECOPUR™	-20 °C...+110 °C				
S-ECOPUR™	-20 °C...+110 °C				
T-ECOPUR™	-50 °C...+110 °C				
G-ECOPUR™	-30 °C...+110 °C	0,5 m/s			
SKF ECORUBBER-1	-30 °C...+100 °C	0,5 m/s	5 m/s	160 bar (16 MPa)	5 bar (0,5 MPa)
SKF ECORUBBER-2	-25 °C...+150 °C				
SKF ECORUBBER-3	-20 °C...+200 °C				
SKF ECORUBBER-H	-50 °C...+150 °C				
SKF ECOFLAS	-10 °C...+200 °C				

The stated operation conditions represent general indications. It is recommended not to use all maximum values simultaneously. Surface speed limits apply only to the presence of adequate lubrication film.

<sup>1</sup> Pressure ratings depend on the size of the extrusion gap.

## Ordering example

K16-B, D=58mm, d=50mm, d1=53mm, L1=3mm, H=12mm, ECOPUR®

**Piston Seal K16-B**  
Profile

**58 x 50/53 x 3/12**  
D x d/d1 x L1/H

**ECOPUR®**  
Sealing material