

**Seal housing**

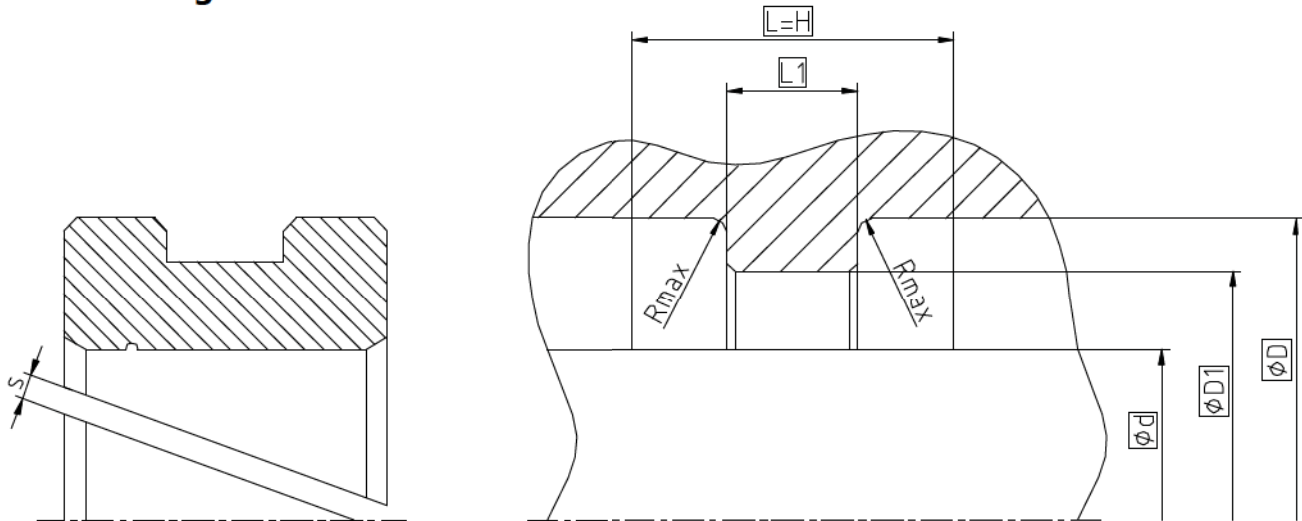

Sealing material	PU/Elastomers		PTFE	
	Rtmax	Ra	Rtmax	Ra
Sliding Surface	≤ 2,5 µm	0,1...0,5 µm	≤ 2 µm	0,05...0,3 µm
Bottom of groove	≤ 6,3 µm	≤ 1,6 µm	≤ 6,3 µm	≤ 1,6 µm
Groove face	≤ 15 µm	≤ 3 µm	≤ 15 µm	≤ 3 µm

Ordering dimensions...□

Bearing area: 50...95% and a cutting depth of 0,5xRz based on Cref = 0%

**Standard dimensions**

minimum nominal inside diameter  $\varnothing d \geq 22\text{mm}$

Depending on the application, the geometry of the guide element should be adapted to the type of application (please refer to the profile description - Seal housing). Because uncut versions would be pointless for assembly reasons, rotating applications should to be avoided. Standard version with cutting gap  $s > 0$  do not allow a supporting function. For a supporting function a cutting gap of  $s=0$  and a spiral groove is provided. cutting gap  $s$ : values depend on material and temperature. For detailed information please refer to the profile description.

**Operating parameters**

Guiding material	Temperature	max. speed	Specific load <sup>2</sup>
SKF ECOFLON 2	-200 °C...+200 °C	4 m/s	3,0 N/mm <sup>2</sup>
SKF ECOFLON 3	-200 °C...+200 °C	5 m/s	4,5 N/mm <sup>2</sup>
SKF ECOFLON 60% Bz.	-200 °C...+200 °C	5 m/s	7,5 N/mm <sup>2</sup>
<b>SKF ECOTAL</b>	<b>-50 °C...+100 °C</b>	<b>4 m/s</b>	<b>25 N/mm<sup>2</sup></b>
SKF ECOMID <sup>1</sup>	-40 °C...+100 °C	4 m/s	25 N/mm <sup>2</sup>
SKF ECOTEX	-40 °C...+130 °C	4 m/s	90 N/mm <sup>2</sup>

The stated operation conditions represent general indications. It is recommended not to use all maximum values simultaneously. Surface speed limits apply only to the presence of adequate lubrication film.

<sup>1</sup> ≤ Ø260mm: SKF ECOTAL ; > Ø260mm: SKF ECOMID

<sup>2</sup> Depending on temperature and allowed compression. Detailed information see profile description.

**Ordering example**

F08, d=100mm, D=109mm, D1=103,5, L=15mm, L1=5mm, SKF ECOTAL

**Guide Ring F08**  
Profile

**100 x 109/103,5 x 15/5**  
d x D/D1 x L/L1

**SKF ECOTAL**  
Guiding material