

**Seal housing**

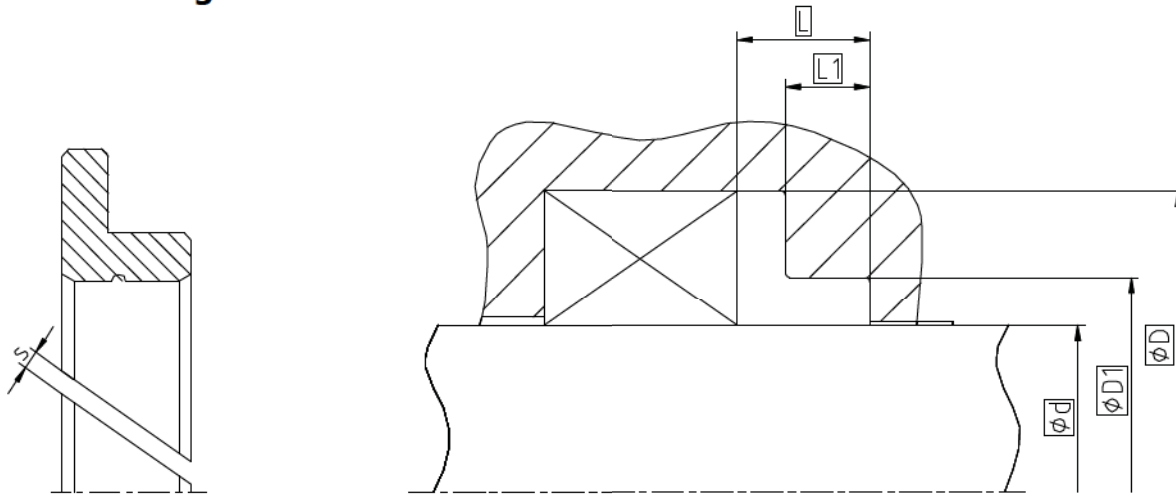

Sealing material	PU/Elastomers		PTFE	
	Rtmax	Ra	Rtmax	Ra
Sliding Surface	≤ 2,5 μm	0,1...0,5 μm	≤ 2 μm	0,05...0,3 μm
Bottom of groove	≤ 6,3 μm	≤ 1,6 μm	≤ 6,3 μm	≤ 1,6 μm
Groove face	≤ 15 μm	≤ 3 μm	≤ 15 μm	≤ 3 μm

Ordering dimensions...□

Bearing area: 50...95% and a cutting depth of 0,5xRz based on Cref = 0%

**Standard dimensions**

Ød f8	ØD <sup>1</sup> H10	ØD1 H8	L +0,2	L1 +0,2
≥ 4 ... < 50	d +10	d + 3	6,5	4
≥ 50 ... < 80	d +15	d + 4	8	4
≥ 80 ... < 150	d +20	d + 5	10,5	5,5
≥ 150 ... ≤ 400	d +25	d + 6	13,4	7
> 400 ... ≤ 750	d +30	d + 8	14,2	7
> 750	d +40		15	7

Basic version: with a cutting gap  $s > 0$  allow no supporting function. For supporting function a cutting gap  $s=0$  and a spiral groove is used.

<sup>1</sup> Cross section usually depends on the seal profile.

cutting gap  $s$  : values depend on material and temperature. For detailed information please refer to the profile description.

**Operating parameters**

Guiding material	Temperature	max. speed	Specific load <sup>2</sup>
SKF ECOFLON 2	-200 °C...+200 °C	4 m/s	3,0 N/mm <sup>2</sup>
SKF ECOFLON 3	-200 °C...+200 °C	5 m/s	4,5 N/mm <sup>2</sup>
SKF ECOFLON 60% Bz.	-200 °C...+200 °C	5 m/s	7,5 N/mm <sup>2</sup>
<b>SKF ECOTAL</b>	<b>-50 °C...+100 °C</b>	<b>4 m/s</b>	<b>25 N/mm<sup>2</sup></b>
SKF ECOMID	-40 °C...+100 °C	4 m/s	25 N/mm <sup>2</sup>
SKF ECOTEX	-40 °C...+130 °C	4 m/s	90 N/mm <sup>2</sup>

The stated operation conditions represent general indications. It is recommended not to use all maximum values simultaneously. Surface speed limits apply only to the presence of adequate lubrication film.

<sup>1</sup> ≤ Ø260mm: SKF ECOTAL ; > Ø260mm: SKF ECOMID

<sup>2</sup> Depending on temperature and allowed compression. Detailed information see profile description.

**Ordering example**

F04, d=100mm, D=80mm, D1=95mm, L=10,5mm L1=5,5mm, SKF ECOTAL

**Guide Ring F04**  
Profile

**100 x 80/95 x 10,5/5,5**  
d x D/D1 x L/L1

**SKF ECOTAL**  
Guiding material